

michael miller FABRICS

Sunflower

SIZE: 95"W x 95"H • LEVEL: CONFIDENT BEGINNER • PATTERN BY: PROJECT HOUSE 360



THIS IS A DIGITAL REPRESENTATION OF THE QUILT TOP, FABRIC MAY VARY.

PLEASE NOTE: BEFORE BEGINNING YOUR PROJECT, CHECK FOR ANY PATTERN UPDATES AT MICHAELMILLERFABRICS.COM'S FREE PROJECTS SECTION.

p.212.704.0774 | info@michaelmillerfabrics.com | www.michaelmillerfabrics.com



Sunflower

1/4" Seam Allowance Check

To check if your seam is accurate, cut three

1 1/2" x 3" pieces from scrap fabric.

Sew the pieces together along the 3" side, using what you believe is a 1/4" seam.

Press away from the center piece.

Measure.

The center piece should be exactly 1" wide.

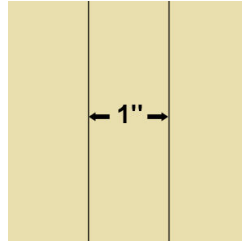

If, when you measure, the center is less than 1", your seam allowance is too large. You need to move the needle to the right.

If it's more than 1", your seam allowance is too small and you need to move the needle to the left.

Consult your machine's owner's manual for instructions on moving your needle position.

Repeat this check until your center strip measures correctly.



FABRIC A

SC5333 cashmere
6 1/2 yards

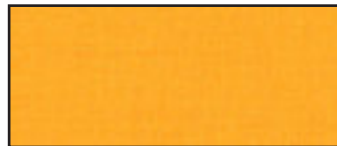

FABRIC B

SC5333 orange blossom
1 1/2 yards

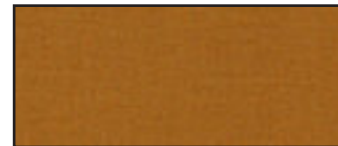

FABRIC C

SC5333 golden brown
1/2 yard



FABRIC D

SC5333 pineapple
2 7/8 yards

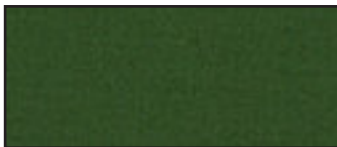

FABRIC E

SC5333 ivy green
1 yard



FABRIC F

SC5333 kelly
1 1/2 yards



FABRIC G

SC5333 clover
1/2 yard



FABRIC H

SC5333 aloe
1 3/4 yards

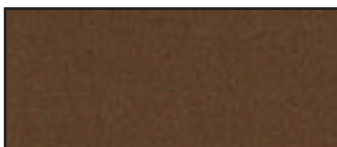

FABRIC I

SC5333 java
1/2 yard



FABRIC J

SC5333 carmine
1/4 yard



BACKING

SC5333 orange blossom
8 3/4 yards

BATTING

103" x 103"



Sunflower

KEY	CUTTING INSTRUCTIONS	WOF=width of fabric
A	(1) 3½" x WOF. Subcut: (20) 2" x 3½" rectangles (1) 5" x WOF. Subcut: (20) 2" x 5" rectangles (1) 6½" x WOF. Subcut: (20) 2" x 6½" rectangles (1) 8" x WOF. Subcut: (20) 2" x 8" rectangles (1) 9½" x WOF. Subcut: (20) 2" x 9½" rectangles (1) 11" x WOF. Subcut: (20) 2" x 11" rectangles (6) 12½" x WOF. Subcut: (16) 12½" squares (3) 10" x WOF. Subcut: (12) 10" squares (6) 10" x WOF	
B	(38) template A (12) small centers (12) large centers	
C	(16) template B (12) template D	
D	(8) 2½" x WOF (10) 2½" x WOF for binding (42) template A (32) small petals (32) large petals	
E	(1) 12½" x WOF. Subcut: (20) 2" x 12½" rectangles (1) 11" x WOF. Subcut: (20) 2" x 11" rectangles	
F	(1) 9½" x WOF. Subcut: (20) 2" x 9½" rectangles (1) 8" x WOF. Subcut: (20) 2" x 8" rectangles (32) template C (200") ¾" straight-grain bias tape*	
G	(1) 6½" x WOF. Subcut: (20) 2" x 6½" rectangles (1) 5" x WOF. Subcut: (20) 2" x 5" rectangles	
H	(2) 3½" x WOF. Subcut: (20) 3½" squares (28) template C (80) small leaf (80) large leaf	
I	(12) small rings (12) large rings	
J	(32) small berries (32) large berries	

* **NOTE:** Bias tape is made using straight-grain strips and a bias tape maker, following manufacturer's instructions.

Sunflower

Block A:

Make 20

1. Stitch one fabric A 2" x 3½" rectangle to one fabric H 3½" square. Press rectangle outward. Add one fabric A 2" x 5" rectangle, then one fabric G 2" x 5" rectangle and one fabric G 2" x 6½" rectangle. Square to 6½".
2. Stitch one fabric A 2" x 6½" rectangle to the block. Add one fabric A 2" x 8" rectangle, one fabric F 2" x 8" rectangle and one fabric F 2" x 9½" rectangle. Square to 9½".
3. Stitch one fabric A 2" x 9½" rectangle to the block. Add one fabric A 2" x 11" rectangle, one fabric E 2" x 11" rectangle and one fabric E 2" x 12½" rectangle. Square to 12½". Make twenty blocks.

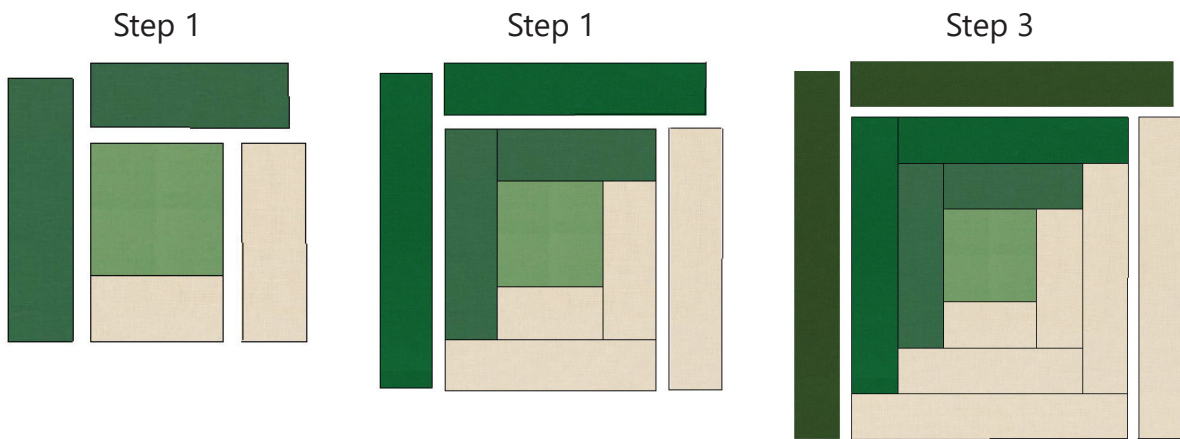

Block B:

Make 10 (6)

4. Fold the long end of one fabric D template A piece in half and stitch along the short edge. Clip corner and turn right-side out. Press seam open from the inside to flatten the point. Make three of these. Repeat with two fabric B template A pieces and stitch the blades together as shown to make a fan.
5. Place fan on one fabric A 12½" square, aligning long raw edges. Applique in place. Remove excess fabric A from the back, leaving a ¼" seam allowance.
6. Turn under the curved edge on one fabric C template B piece. Applique in place. Square block to 12½". Make ten blocks.
7. Repeat steps 4-6 to make six more blocks using three fabric B template A pieces and two fabric D template A pieces.

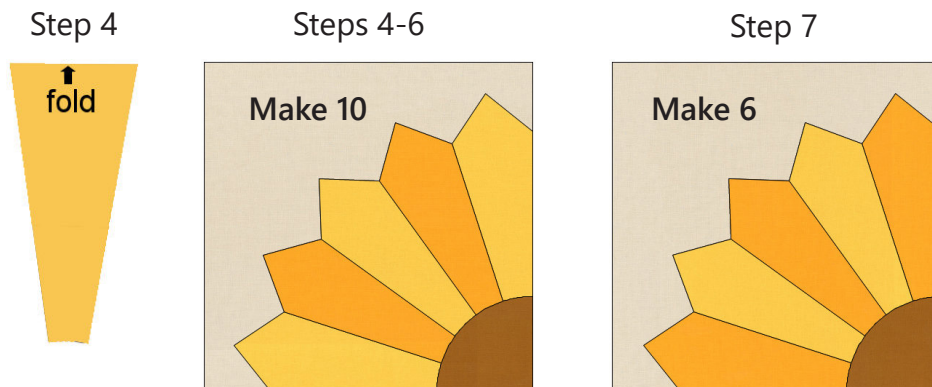

Sunflower

Block C:

Make 8 (4)

8. Make as for block B using three fabric F template C, two fabric H template C, one fabric C template D and one fabric B 10" square. Square to 10". Make eight blocks.

9. Make as for block B using three fabric H template C, two fabric F template C, one fabric C template D and one fabric B 10" square. Square to 10". Make four blocks.

Step 8

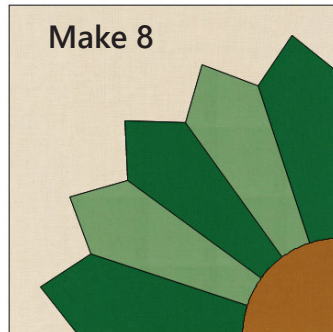

Step 9

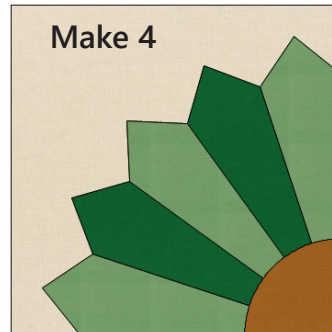

Assembly:

Refer to the assembly diagram on page when needed.

10. Stitch blocks A and B together as shown to create the quilt center, being mindful of block rotation and placement.

11. Stitch eight fabric D 2½" x WOF strips together in pairs. Add to the quilt, mitering corners.

12. Prepare "small" pieces for applique and add to the quilt as shown on the cover image using your favorite applique method.

13. Cut two fabric A 10" x WOF strips in half. Add a whole strip to each piece and cut them to 10" x 57½".

14. Add one block C to each end of two strips and add to the left- and right-hand sides of the quilt. Add two block C to each end of each remaining strips and add to the top and bottom of the quilt.

15. Prepare "large" pieces for applique and add them to the quilt as shown on the cover image using your favorite applique method.

Finishing:

16. Layer, baste and quilt as desired.

17. Bind with ten fabric D 2½" x WOF strips.

Sunflower

Assembly Diagram - No Applique

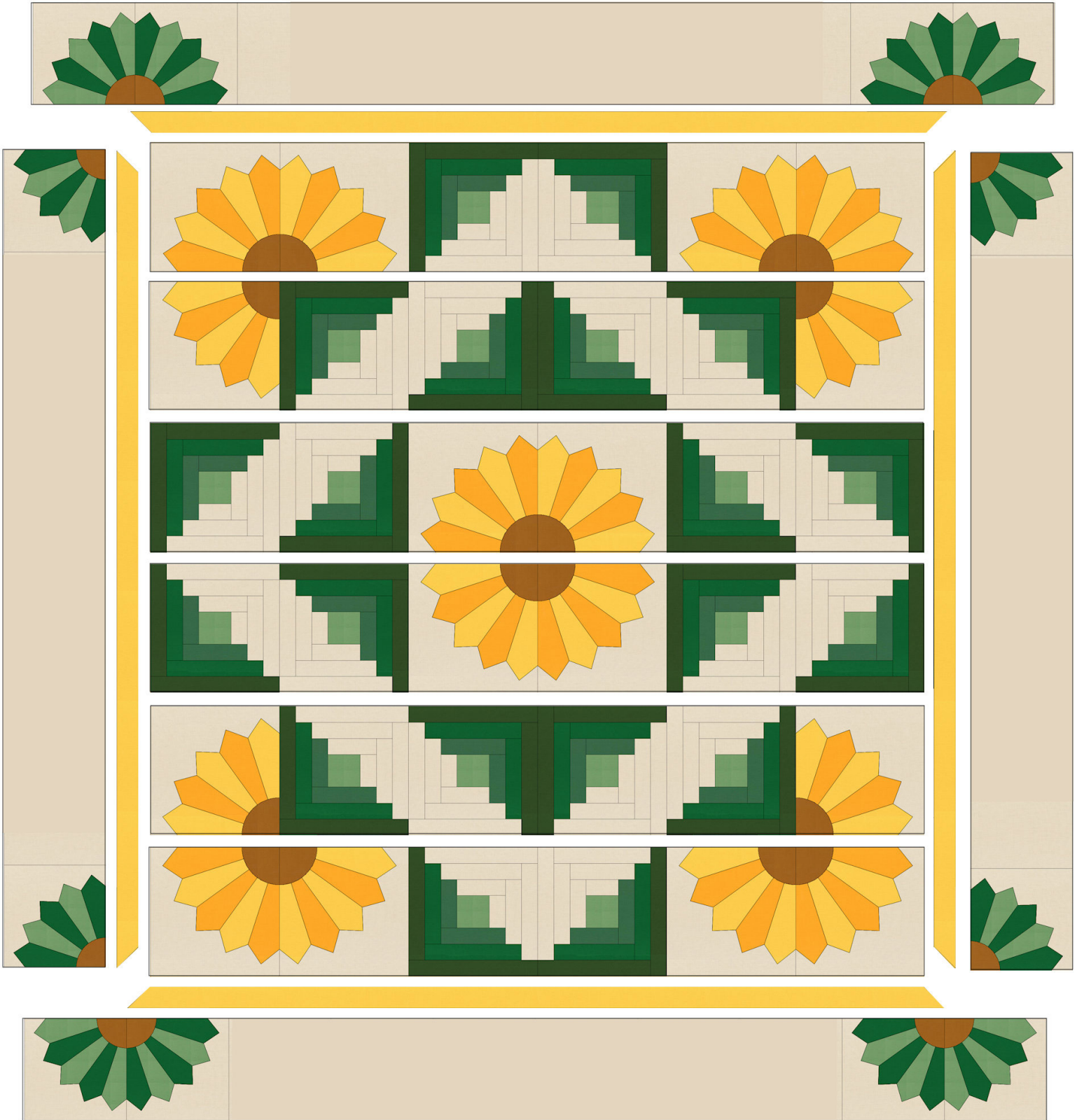



Sunflower

square
measures
1"

large
berry

large
petal

large
ring

large
center

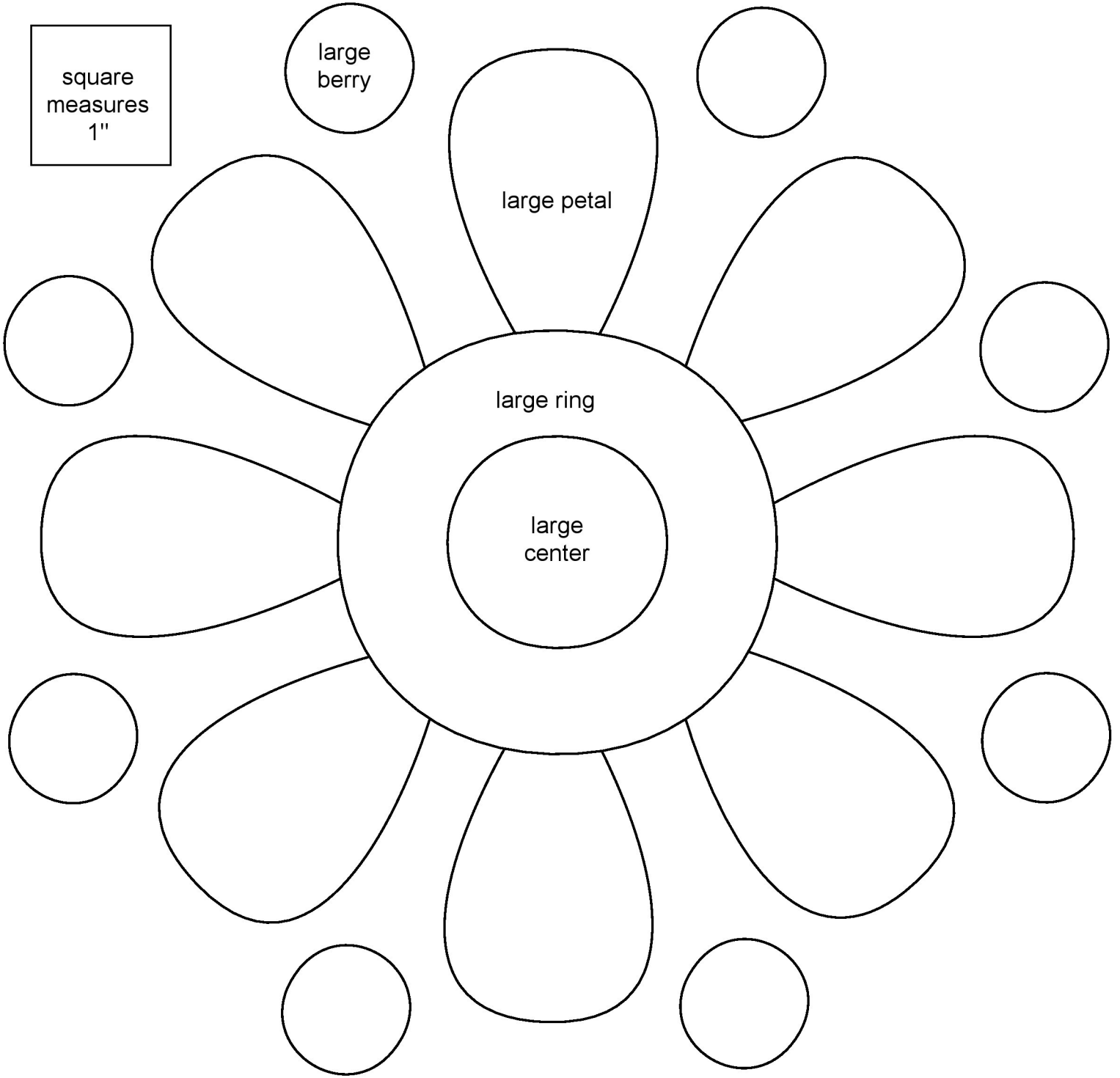

Sunflower

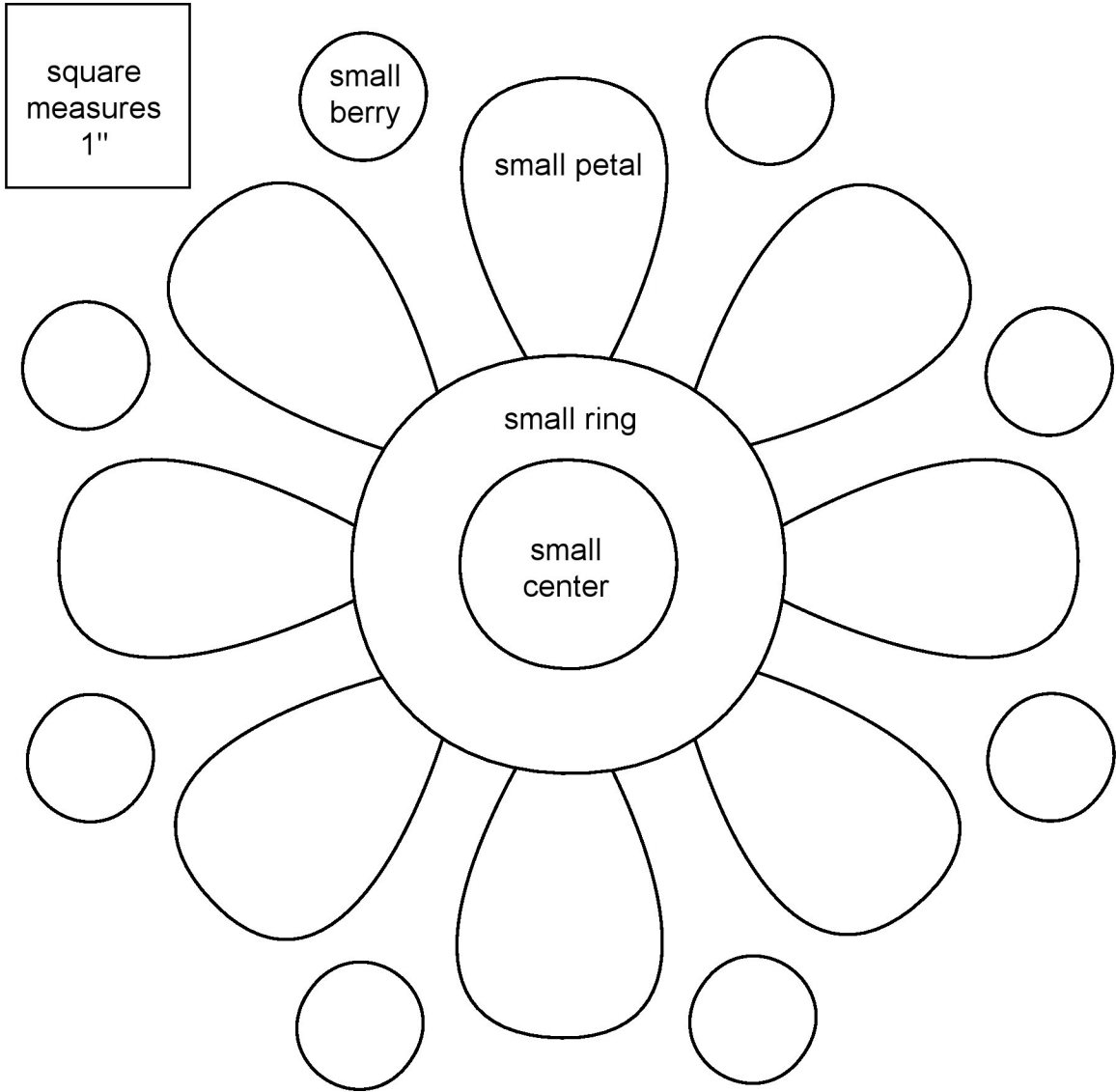

Sunflower

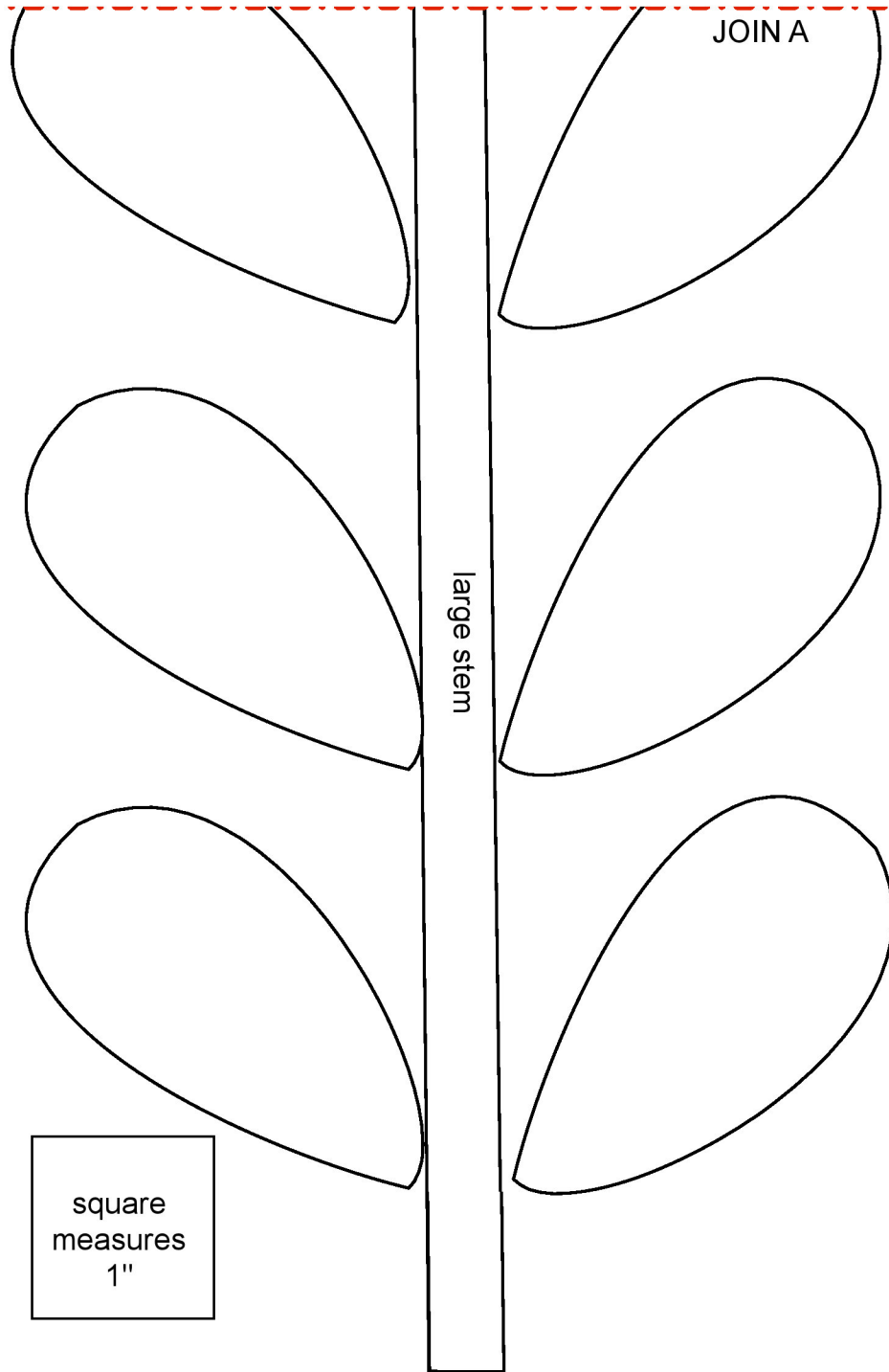

Sunflower

square
measures
1"

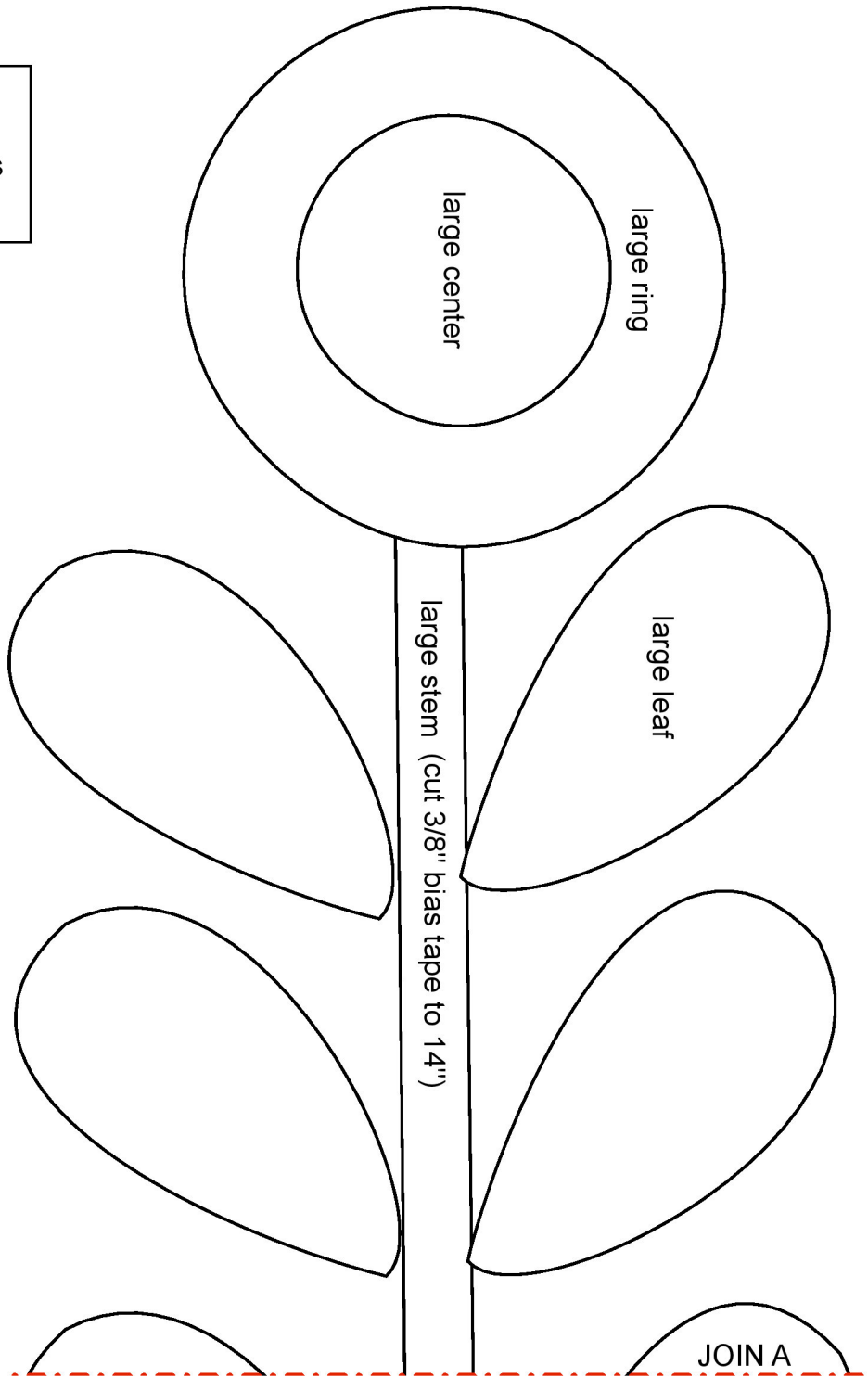

Sunflower

square
measures
1"

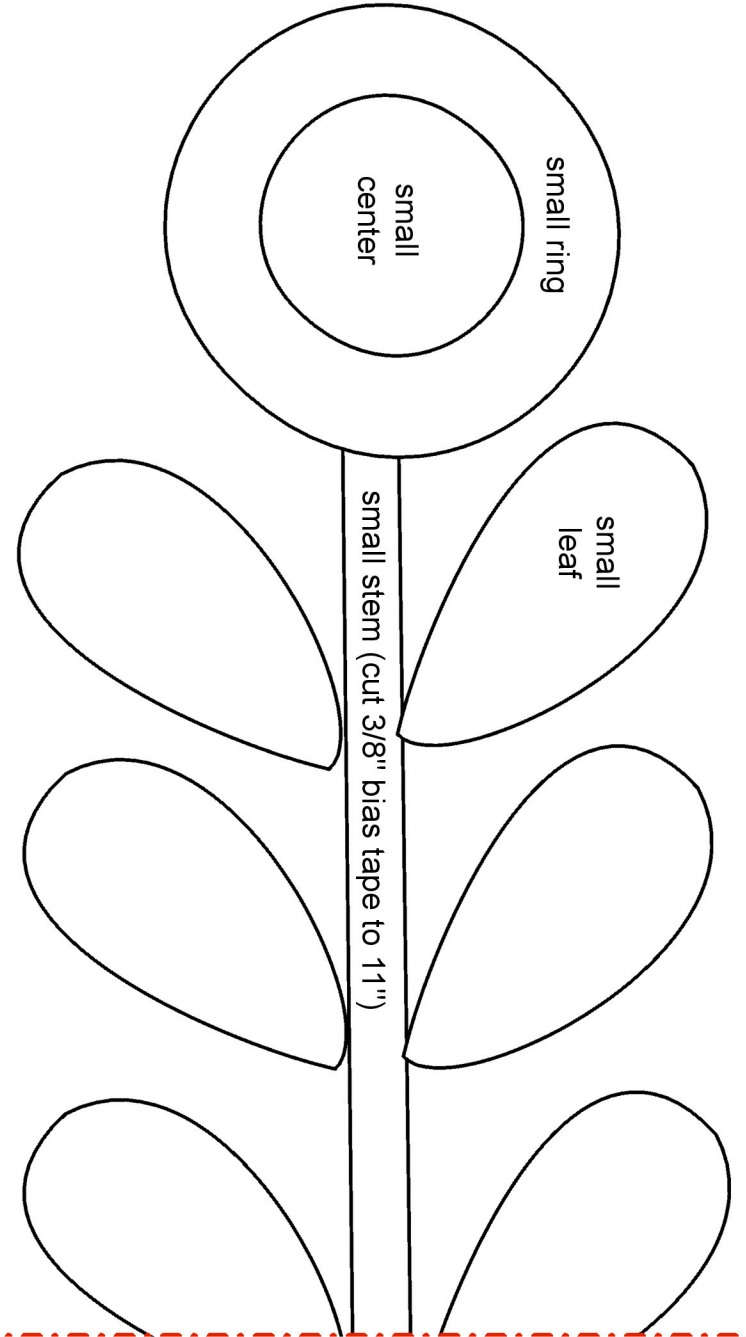

Sunflower

square
measures
1"

