

michael miller FABRICS

Queen's Romance

SIZE: 67-1/2" x 67-1/2" • LEVEL: Intermediate • PATTERN BY: Marsha Evans Moore • FABRIC COLLECTION: Hampton Court

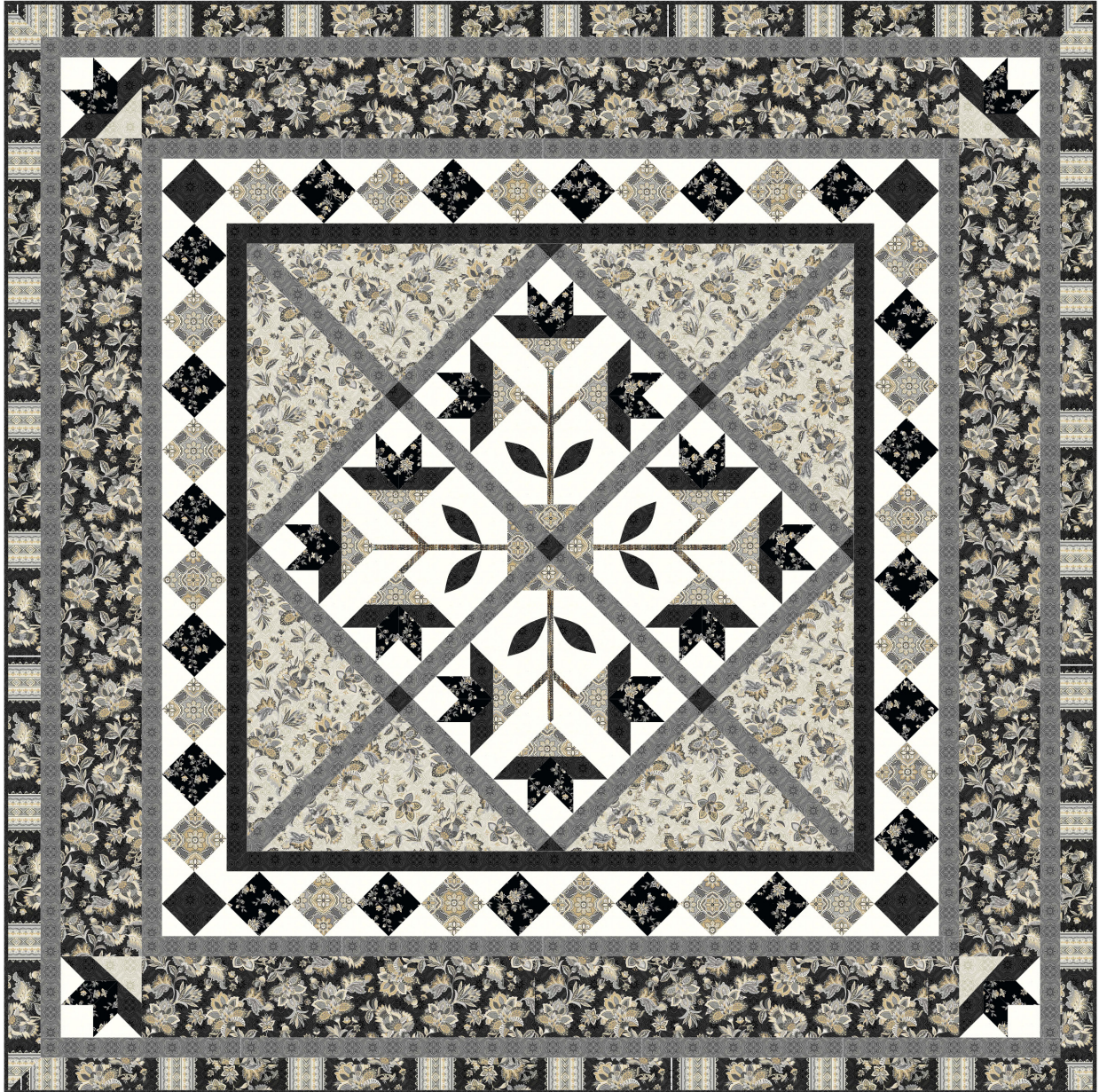

THIS IS A DIGITAL REPRESENTATION OF THE QUILT TOP, FABRIC MAY VARY.

PLEASE NOTE: BEFORE BEGINNING YOUR PROJECT, CHECK FOR ANY PATTERN UPDATES AT MICHAELMILLERFABRICS.COM'S FREE PROJECTS SECTION.

p.212.704.0774 | info@michaelmillerfabrics.com | www.michaelmillerfabrics.com



Queen's Romance



FABRIC A
DCX11632_Cream
7/8 yard



FABRIC B
DCX11632_Black
1 yard



FABRIC C
DCX11634_Gray
1/2 yard



FABRIC D
DCX11635_Black
5/8 yard



FABRIC E
CX11636_Gray
1 yard



FABRIC F
CX11636_Cream
1/4 yard

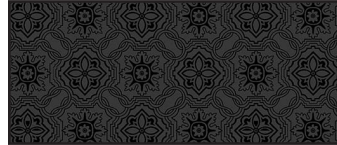

FABRIC G
CX11636_Black
1-1/8 yard



FABRIC H
CX11637_Black
1/2 yard



FABRIC I
CX11638_Gray
1/4 yard



FABRIC J
Sc5333_Parchment
1-1/8 yard



Queen's Romance

KEY	CUTTING INSTRUCTIONS
A	(4) 12-7/8" squares; cut in half diagonally once to make (8) triangles.
B	(5) 5-5/8" x 42" strips, sew short ends together. Subcut (4) 5-5/8" x 51" borders.
C	(1) 3-7/8" x 42" strip; subcut (6) 3-7/8" squares. Cut squares in half diagonally once to make (12) 3-7/8" triangles. (2) 3-3/8" x 42" strips; subcut (20) 3-3/8" squares and (4) 3" squares.
D	(7) 2-1/2" x 42" strips; sew ends together matching stripes. Subcut (4) 2-1/2" x 68-3/4" borders; trim ends diagonally.
E	(11) 1-3/4" x WOF strips, sew ends together. Subcut (2) 1-3/4" x 63-3/4" borders, (2) 1-3/4" x 61-1/4" borders, (2) 1-3/4" x 51" borders and (2) 1-3/4" x 48-1/2" borders. (6) 1-3/4" x 42" strips; subcut (4) 1-3/4" x 13-1/2" strips and (12) 1-3/4" x 12" strips.
F	(1) 3-7/8" x 42" strip; subcut (2) 3-7/8" squares. Cut 3-7/8" squares in half diagonally once to make (4) 3-7/8" triangles.
G	(3) 2" x 42" strips; subcut (32) Diamond templates. (4) 1-3/4" x 42" strips; subcut (2) 1-3/4" x 38" borders, (2) 1-3/4" x 40-1/2" borders, and (5) 1-3/4" squares. (2) 2-5/8" squares; cut squares in half diagonally once to make (4) 2-5/8" triangles. (8) Leaf templates. (4) 3-3/8" squares. FOR BINDING: (7) 2-1/4" x 42" strips, sew short ends together.
H	(2) 3-3/8" x 42" strips; subcut (20) 3-3/8" squares. (3) 2" x 42" strips; subcut (32) Diamond templates.
I	For raw edge appliqué stems: (4) 3/8" x 9" strips and (8) 3/8" x 3" strips. For turned under appliqué stems: (4) 1-1/2" x 10" bias strips and (4) 1-1/2" x 8" bias strips.
J	(1) 7-3/8" x 42" strip; subcut (4) 7-3/8" squares and (2) 3" squares. (1) 3" x 42" strip; subcut (14) 3" squares. Cut (16) 3" squares in half diagonally once to make (32) 3" triangles. (2) 2-1/4" x 42" strips; subcut (8) 2-1/4" x 5-5/8" rectangles. (1) 2-5/8" x 42" strip; subcut (16) 2-5/8" squares.

Continued on page 3.

Queen's Romance

KEY	CUTTING INSTRUCTIONS
J	(3) 5-1/4" x 42" strips; subcut (20) 5-1/4" squares. Cut 5-1/4" squares in half diagonally twice to make (80) triangles. (1) 2-7/8" x 42" strip; subcut (8) 2-7/8" squares. Cut 2-7/8" squares in half diagonally once to make (16) triangles.
	75" x 75" batting.

ADDITIONAL MATERIALS

4-3/8 yards backing fabric

Water soluble fabric marker

Rotary cutter, ruler and mat

Thread to match fabrics

Basic sewing supplies

Sewing machine

Template plastic

Optional: For turned under edge appliqué: freezer paper or other template paper.

For raw edge appliqué: paper backed fusible webbing.

BLOCKS

Note: Measure and mark the end of the seamline at the side corner on the wrong side, if necessary, to ensure accuracy when sewing the diamonds together.

1. Sew (1) **G** diamond and (1) **H** diamond together beginning at the center point and ending at the side corner of the seamline to make a **G/H** diamond pair. Make 1.

2. Sew (1) **H** diamond and (1) **G** diamond together in the same way to make an **H/G** diamond pair. Make 1.

3. Sew (1) **G** diamond of the **G/H** diamond pair to (1) **J** 3" triangle ending at the corners of the seamline.

4. Sew (1) **H** diamond to adjacent side of **J** 3" triangle beginning at the side corner of the seamline to make a diamond pair unit. Make 1.

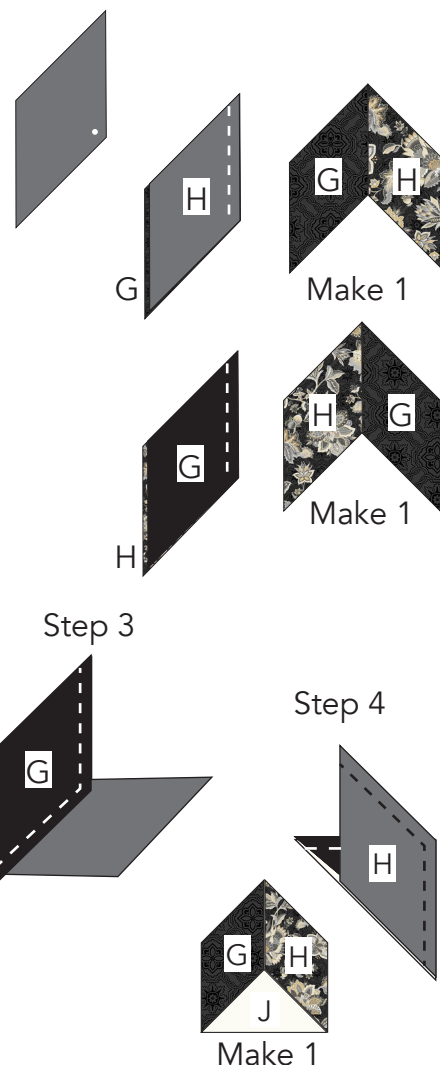

Queen's Romance

5. Following steps 3-4, sew (1) **H/G** diamond pair to (1) **J** 3" triangle to make a diamond pair unit. Make 1.

6. Sew the **G/H** and **H/G** diamond pair units together beginning at the center point and ending at the side corner of the seamline.

7. Following steps 3-4, sew (1) **J** 2-5/8" square between the points of the diamonds. Sew (1) **C** 3-7/8" triangle to the **G** diamonds to make a lily unit. Lily unit should measure 5-5/8" square including seam allowance. Make 3.

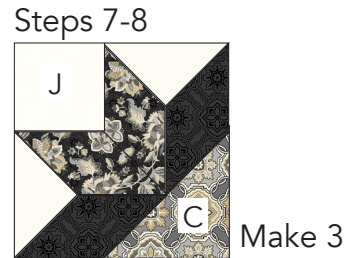
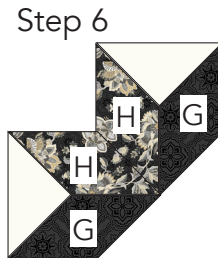

8. Using your favorite appliqué method, prepare the appliqué pieces. Prepare raw edge appliqué stems in the same way as other pieces.

9. For turned edge appliqué stems, fold (4) **I** 8" and (4) **I** 6" strips in half lengthwise with wrong sides together. Sew 3/8" from fold. Trim raw edge 1/8" from stitching. Press stem flat with seam centered on one side. Make 4 each. Cut (4) 8" stems in half to (8) 2-3/4" stems.

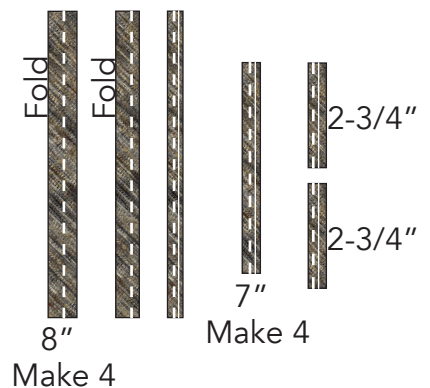

10. Trace appliqué pattern to (1) **J** 7-3/8" square.

11. Pin, baste or fuse (2) **I** 2-3/4" stems to position on **J** 7-3/8" square. Trim ends diagonally along diagonal stem. Sew along long edges of stems using your preferred method of appliqué.

12. Pin, baste or fuse (1) **I** 9" stem diagonally on **J** 7-3/8" square. Sew along edges stopping stitching at dots and leaving stem free near top corner. Pin, baste or fuse (2) **G** leaf appliqués to position. Sew along edges of leaves.

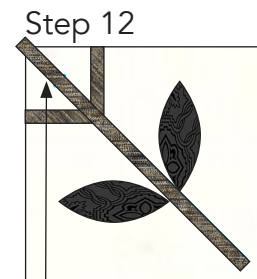
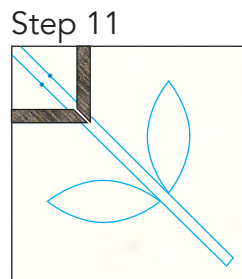
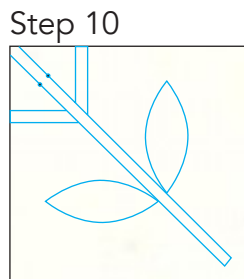

Do not stitch stem above dots.

Queen's Romance

13. Draw a diagonal line on the wrong side of (4) **C** 3" squares.

14. Place (1) **C** 3" square right side down on lower right corner of **J** 7-3/8" square. Sew along drawn line. Trim fabric 1/4" from stitching as indicated by solid line.

15. Press **C** triangle open.

Step 13



Step 14

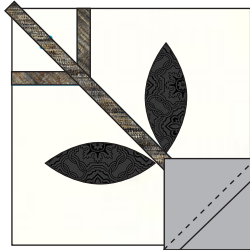

Step 15

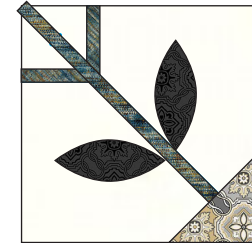

Make 1

16. Sew (1) **J** 2-1/4" x 5-5/8" rectangle to (1) lily unit beginning 3/4" from edge of fabric. Note orientation of lily unit. Press seam open.

17. Sew (1) lily unit to opposite edge of **J** 2-1/4" x 5-5/8" rectangle to make left side of block. Press seam open.

18. Sew (1) **J** 2-1/4" x 5-5/8" rectangle to (1) lily unit. Fold stem back so it is not caught in seam. Sew **J** appliqué unit to lower edge of lily/rectangle unit. Press seam open.

19. Sew left side to right side leaving an opening in the seam as shown. Press the seam open.

Step 16



Step 17



Step 18

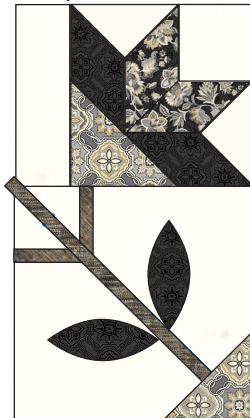

Step 19

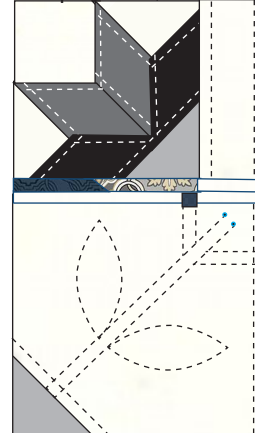

Leave open here.

20. Insert top of the diagonal stem in opening at the corner of the lily unit. Sew the top section of the stem in place. Press the edges of the opening in corner of the **C** triangle in place and sew the opening closed. Make 4.

Make 4



Queen's Romance

QUILT CENTER

- 21.** Arrange the blocks in (2) columns of (2) blocks each. Note orientation of blocks. Sew (3) **E** 1-3/4" x 12-1/2" strips alternating with (2) blocks to make the block rows. Make 2.
- 22.** Sew (3) **G** 1-3/4" squares alternating with (2) **E** 1-3/4" x 12-1/2" strips to make the center sashing column. Make 1.
- 23.** Sew (2) **G** 2-5/8" triangles and (1) **G** 1-3/4" square alternating with (2) **E** 1-3/4" x 12-1/2" strips to make the side sashing column. Note orientation of **G** triangles. Make 2.
- 24.** Sew (2) side sashing columns and (1) center sashing column alternating with (2) block columns to complete the center block. Make 1.



- 25.** Sew (2) **A** 12-7/8" triangles to the sides of (1) **E** 2" x 2" x 13-1/2" strips. Trim end of strip even with the edge of the triangles to complete an **A/E** triangle pair. Make 4.

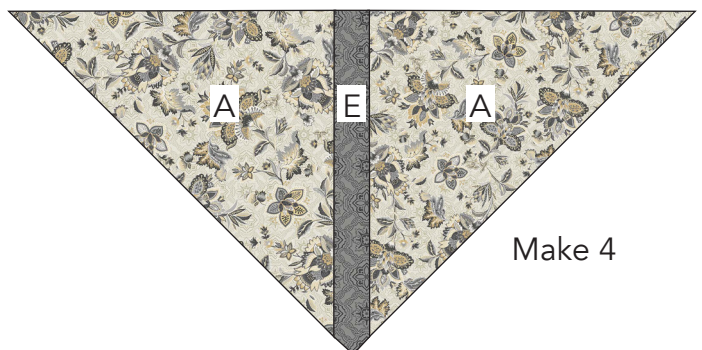

Queen's Romance

PATCHWORK BORDERS

26. Sew (1) **J** 2-7/8" triangle and (1) **J** 5-1/4" triangle to opposite sides of (1) **H** 3-3/8" square to make (1) **H** end unit. Make 2.

27. Sew (1) **J** 2-7/8" triangle and (1) **J** 5-1/4" triangle to opposite sides of (1) **C** 3-3/8" square to make (1) **C** end unit. Make 2.

28. Sew (1) **J** 2-7/8" triangle and (1) **J** 5-1/4" triangle to opposite sides of (1) **G** 3-3/8" square to make (1) **G** end unit. Make 4.

29. Sew (2) **J** 5-1/4" triangles to opposite sides of (1) **H** 3-3/8" square to make **H** triangle/square units. Make 18.

30. Sew (2) **J** 5-1/4" triangles to opposite sides of (1) **C** 3-3/8" square to make **C** triangle/square units. Make 18.

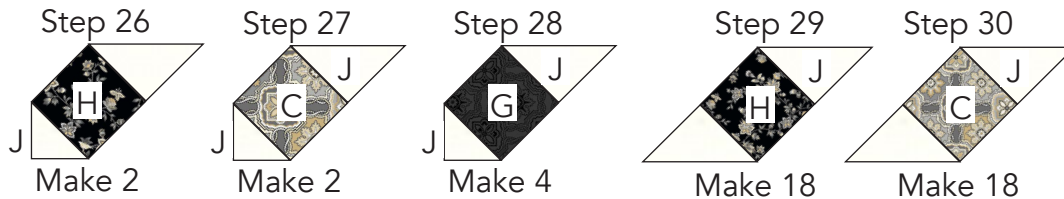

31. Sew together (4) **C** triangle/square units alternating with (4) **H** triangle/square units matching seams. Sew (1) **C** end unit and (1) **H** end unit to ends. Sew (2) **J** 2-7/8" triangles to corners to complete side borders. Side borders should measure 4-1/2" x 40-1/2" including seam allowance. Make 2.

Side Borders

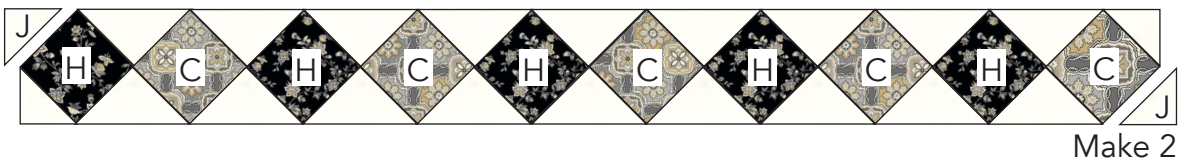

32. Sew together (5) **C** triangle/square units alternating with (5) **H** triangle/square units matching seams. Sew (2) **G** end units to ends. Sew (2) **J** 2-7/8" triangles to corners to complete top and bottom borders. Top and bottom borders should measure 4-1/2" x 48-1/2" including seam allowance. Make 2.

Top and Bottom Borders

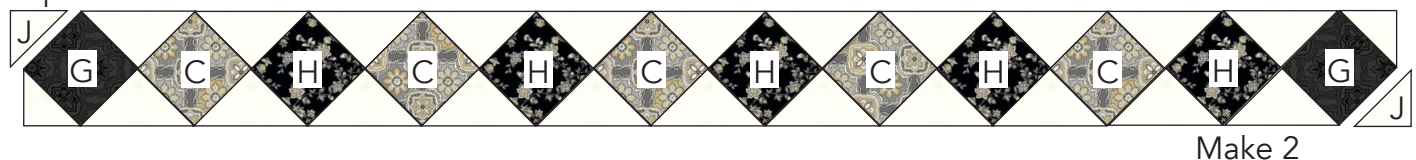

33. Following steps 1-7, make corner squares substituting (1) **F** 3-7/8" triangle. Make 4.





Queen's Romance

QUILT ASSEMBLY

- 34.** Following the quilt layout diagram on page 9, sew (1) **A/E** triangle pair to each side of the center blocks to complete the quilt center. Quilt center should measure approximately 38" including seam allowance.
- 35.** Sew (2) **G** 1-3/4" x 38" borders to the sides of the quilt center. Sew (1) **G** 1-3/4" x 40-1/2" border to top and bottom of the quilt.
- 36.** Sew (2) side patchwork borders to the sides of the quilt. Sew (2) top and bottom borders to top and bottom of quilt.
- 37.** Sew (2) **E** 1-3/4" x 48-1/2" borders to the sides of the quilt. Sew (2) **E** 1-3/4" x 51" borders to top and bottom of quilt.
- 38.** Sew (2) **B** 5-5/8" x 51" borders to the sides of the quilt. Sew (2) corner squares to ends of (2) **B** 5-5/8" x 51" borders noting orientation of corner squares. Sew to the top and bottom of the quilt.
- 39.** Sew (2) **E** 1-3/4" x 61-1/4" borders to the sides of quilt. Sew (2) **E** 1-3/4" x 63-3/4" borders to top and bottom of quilt.
- 40.** Sew (4) **D** 2-1/2" x 68-3/4" borders to sides of the quilt beginning and ending stitching 1/4" from ends of seam. Sew diagonal edges of adjacent borders together.

Templates

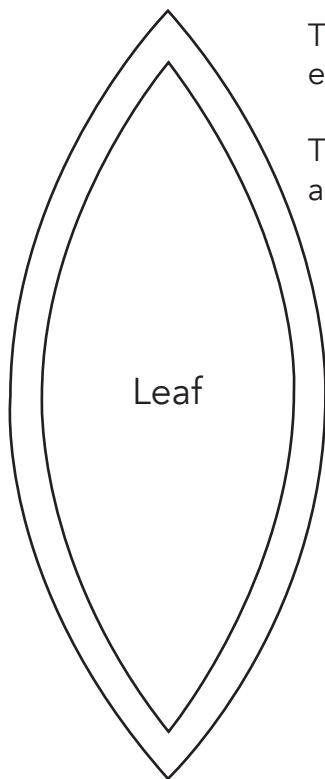

Trace outer lines for turned edge appliqué.

Trace inner lines for raw edge appliqué or paper templates.

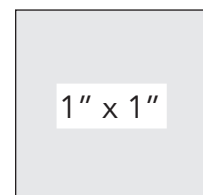
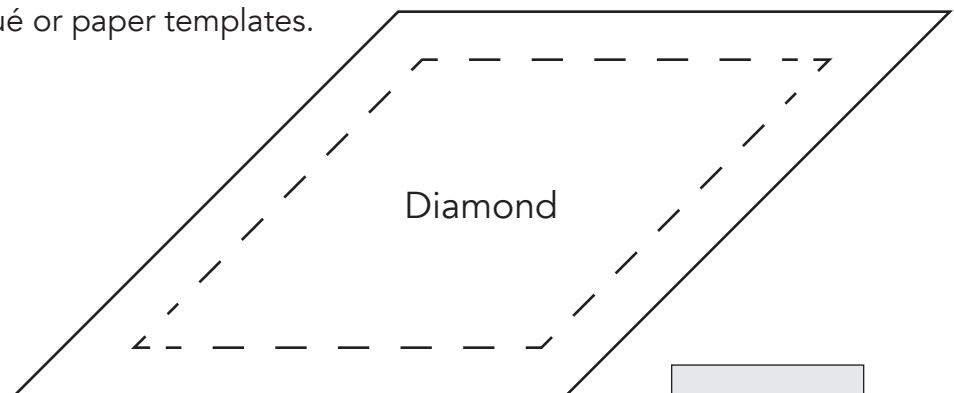

Print at 100%.

Queen's Romance

Quilt Layout

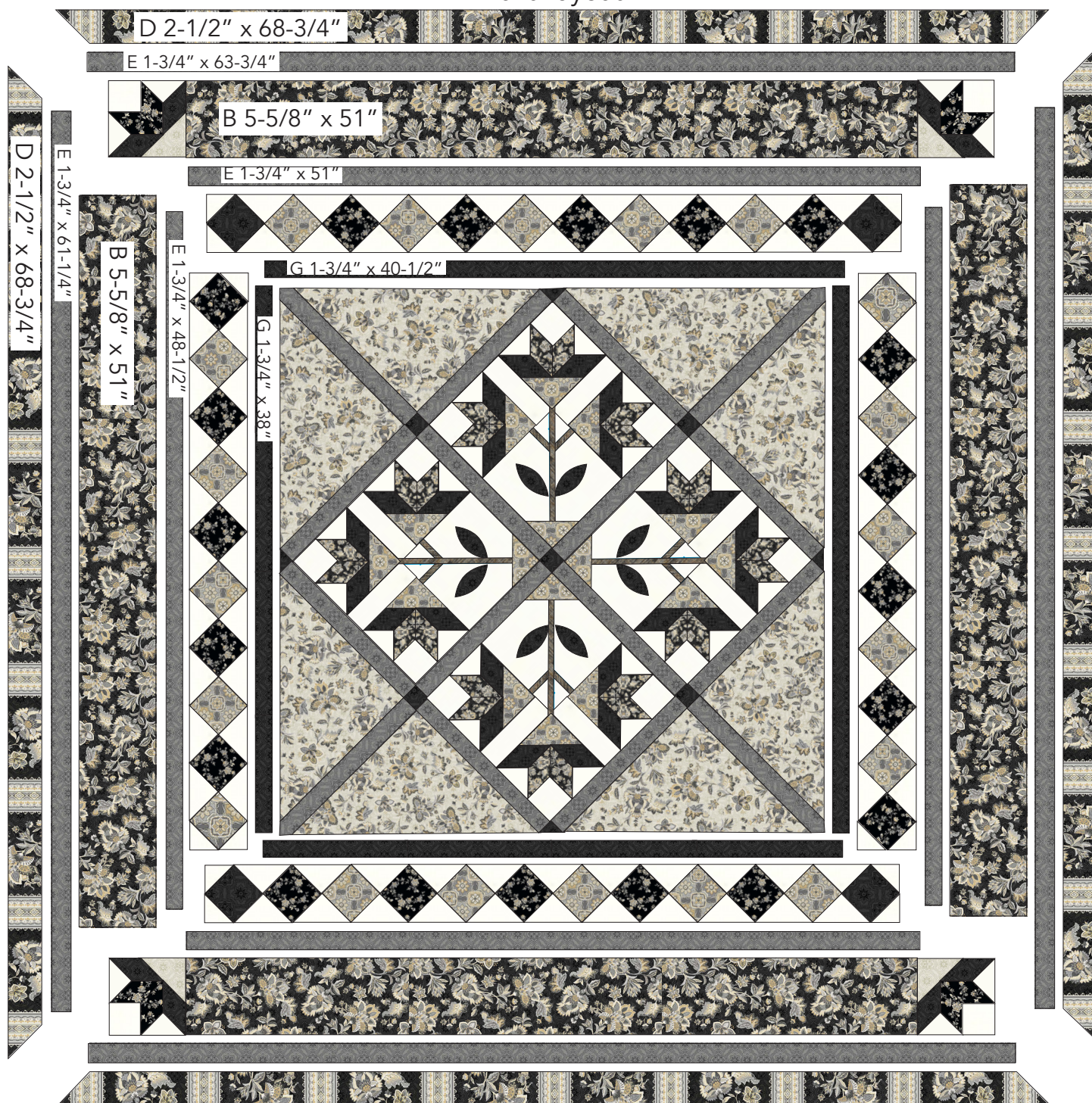

FINISHING: Layer quilt top, batting and backing together to form quilt sandwich. Baste and quilt as desired. Bind using seven fabric **G** 2-1/4" strips.



Queen's Romance

Appliqué Pattern

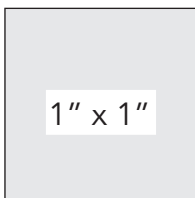
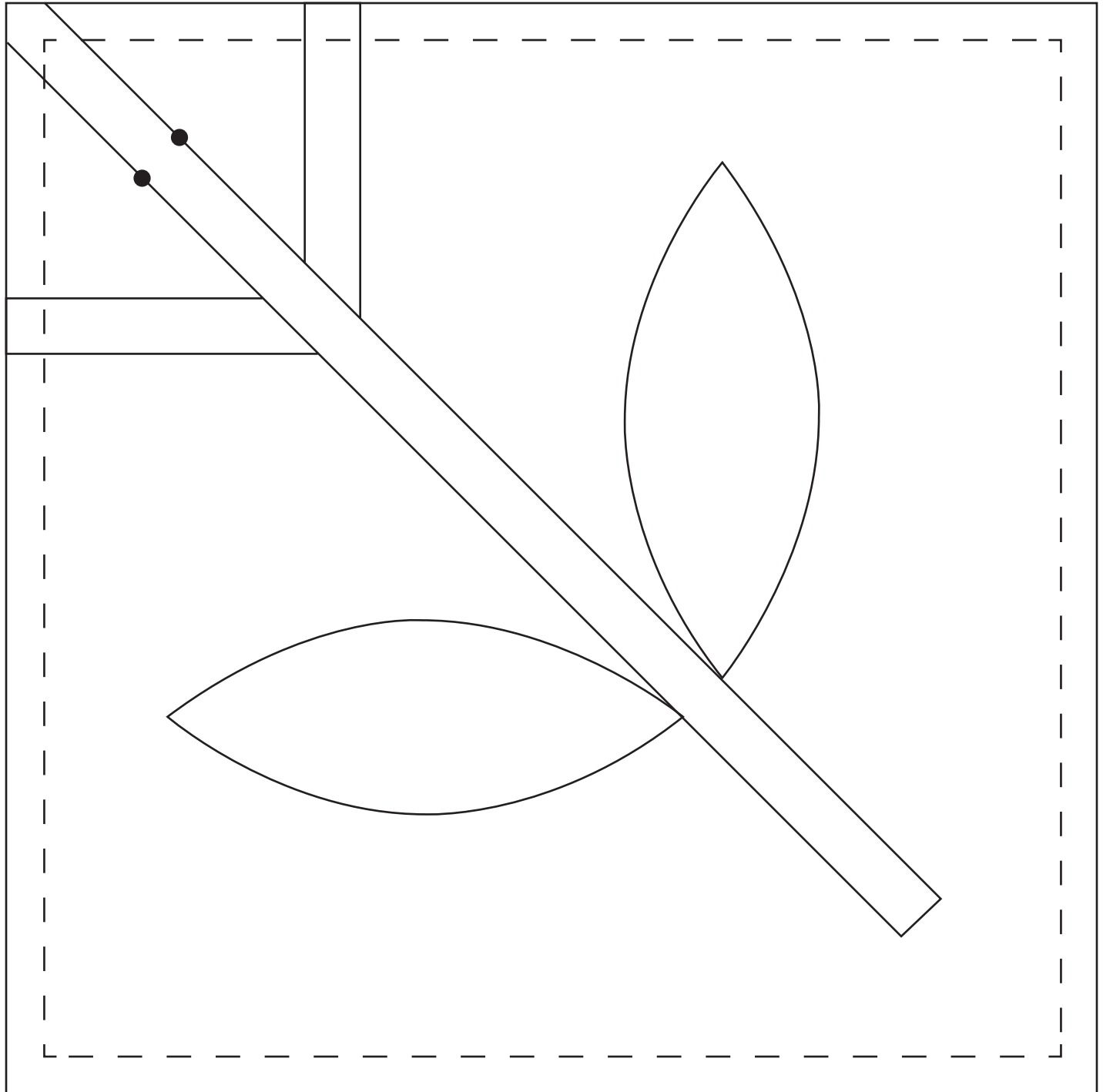

Print at 100%.