

michael miller FABRICS

SHIMMERING STARS

SIZE: 63-1/2" x 63-1/2"

• LEVEL: INTERMEDIATE

• PATTERN BY: MARSHA EVANS MOORE

FABRIC COLLECTION: FAIRY FROST

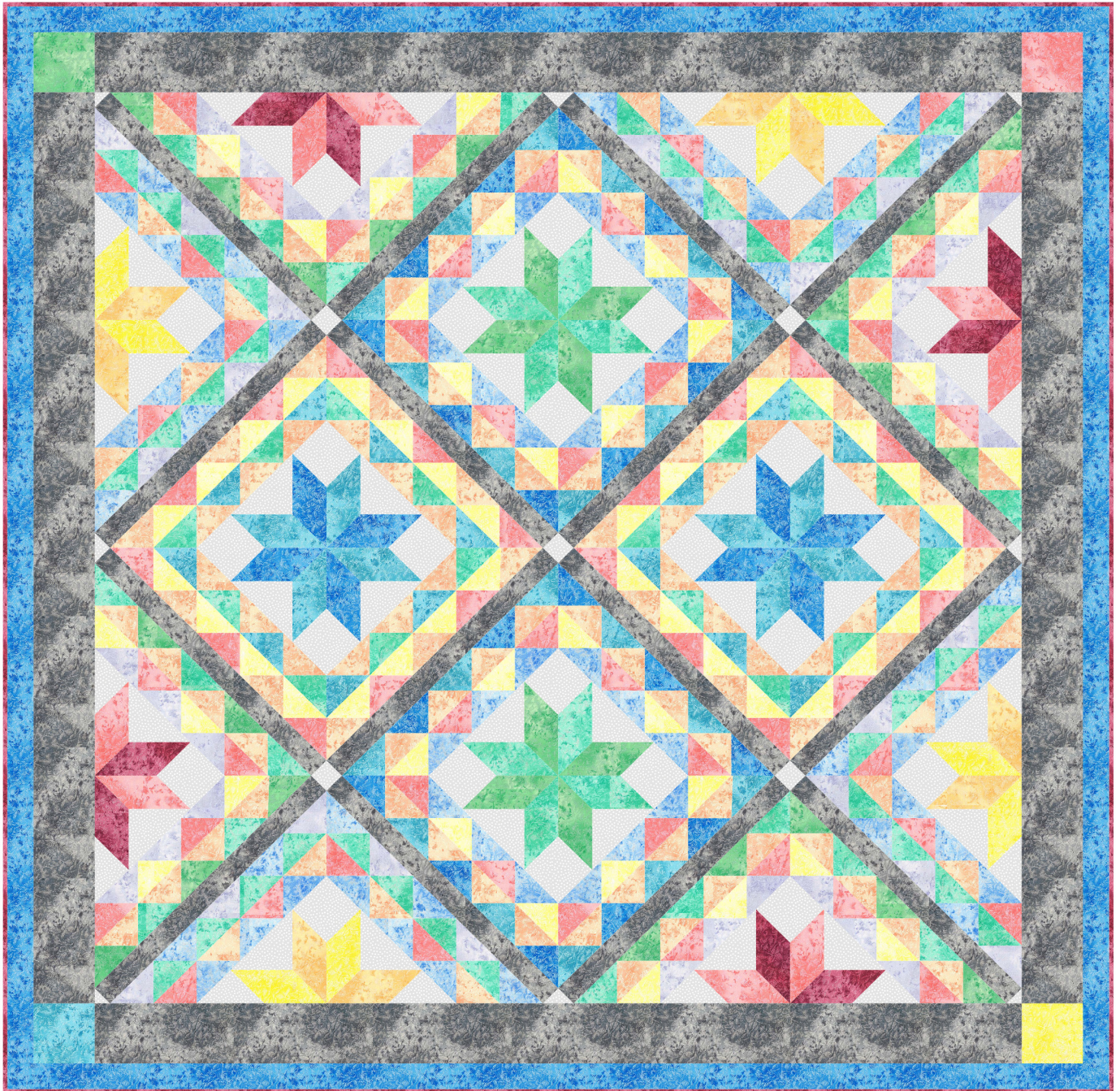

THIS IS A DIGITAL REPRESENTATION OF THE QUILT TOP, FABRIC MAY VARY.

PLEASE NOTE: BEFORE BEGINNING YOUR PROJECT, CHECK FOR ANY PATTERN UPDATES AT MICHAELMILLERFABRICS.COM'S FREE PROJECTS SECTION.

p.212.704.0774 | info@michaelmillerfabrics.com | www.michaelmillerfabrics.com



SHIMMERING STARS

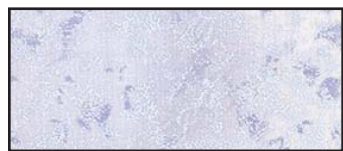

FABRIC A
CMO376_Sugarplum
3/8 yard

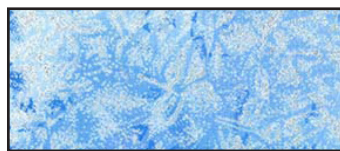

FABRIC B
CMO376_Sailor
3/8 yard

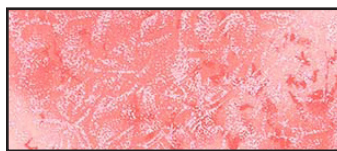

FABRIC C
CMO376_Geranium
5/8 yard

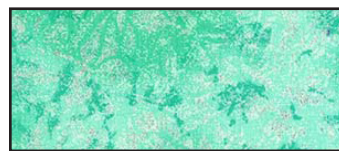

FABRIC D
CMO376_Oasis
5/8 yard



FABRIC E
CMO376_Citrus
1/4 yard



FABRIC F
CMO376_Carrot
1/8 yard

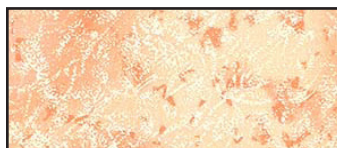

FABRIC G
CMO376_Peach
3/4 yard



FABRIC H
CMO376_Voyage
1/2 yard

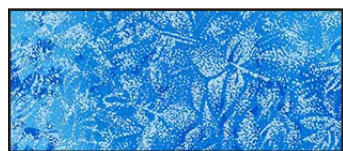

FABRIC I
CMO376_Beacon
3/4 yard



FABRIC J
CMO376_Firefly
1/2 yard

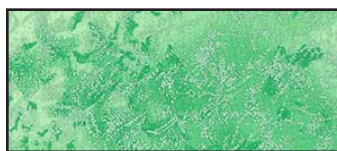

FABRIC K
CMO376_Julep
3/8 yard

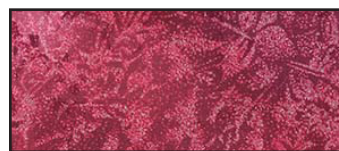

FABRIC L
CMO376_Garnet
5/8 yard



FABRIC M
SC5333_softwhite
1-3/8 yard



FABRIC N
C10410_White
7/8 yard



SHIMMERING STARS

KEY	CUTTING INSTRUCTIONS
A	(2) 4-3/4" x 42" strips; subcut (11) 4-3/4" squares. Cut squares in half diagonally twice to make (44) triangles.
B	(2) 4-3/4" x 42" strips; subcut (16) 4-3/4" squares. Cut squares in half diagonally twice to make (64) triangles.
C	(2) 3-3/8" x 42" strips; subcut (24) 3-3/8" squares. (1) 4-3/4" strip; subcut (5) 4-3/4" squares and (1) 4" square. Cut 4-3/4" squares in half diagonally twice to make (20) triangles. (1) 2-1/2" x 42" strip; subcut (8) diamond templates.
D	(2) 3-3/8" x 42" strips; subcut (24) 3-3/8" squares. (1) 4-3/4" strip; subcut (5) 4-3/4" squares. Cut 4-3/4" squares in half diagonally twice to make (20) triangles. (1) 2-1/2" x 42" strip; subcut (8) diamond templates reversed.
E	(1) 2-1/2" x 42" strip; subcut (8) diamond templates. (1) 4" square.
F	(1) 2-1/2" x 42" strip; subcut (8) diamond templates reversed.
G	(4) 3-3/8" x 42" strips; subcut (40) 3-3/8" squares. (2) 4-3/4" x 42" strips; subcut (11) 4-3/4" squares. Cut squares in half diagonally twice to make (44) triangles.
H	(1) 3-3/8" x 42" strip; subcut (8) 3-3/8" squares. (1) 4-3/4" x 42" strip; subcut (5) 4-3/4" squares and (1) 4" square. Cut 4-3/4" squares in half diagonally twice to make (20) triangles. (1) 2-1/2" x 42" strip; subcut (8) diamond templates.
I	(6) 2" x 42" strips, sew short ends together. Subcut (2) 2" x 60-1/2" borders and (2) 2" x 63-1/2" borders. (2) 3-3/8" x 42" strips; subcut (20) 3-3/8" squares. (1) 2-1/2" x 42" strip; subcut (8) diamond templates reversed.
J	(3) 3-3/8" x 42" strips; subcut (32) 3-3/8" squares.
K	(1) 4-3/4" x 42" strip; subcut (5) 4-3/4" squares and (1) 4" square. Cut 4-3/4" squares in half diagonally twice to make (20) triangles. (1) 2-1/2" x 42" strip; subcut (8) diamond templates.

SHIMMERING STARS

KEY	CUTTING INSTRUCTIONS
L	(1) 2-1/2" x 42" strip; subcut (8) diamond templates reversed. FOR BINDING: (7) 2-1/4" x 42" strips, sew short ends together.
M	(6) 4" x 42" strips, sew short ends together. Subcut (4) 4" x 53-1/2" borders. (8) 2" x 42" strips; subcut (16) 2" x 18" strips.
N	(2) 3-3/8" x 42" strips; subcut (24) 3-3/8" squares. (1) 3-3/4" x 42" strip; subcut (8) 3-3/4" squares. Cut squares in half diagonally once to make (16) Medium Triangles. (2) 6" x 42" strips; subcut (8) 6" squares. Cut squares in half diagonally twice to make (32) Large Triangles. (1) 2-3/8" x 42" strip; subcut (2) 2-3/8" squares and (7) 2" squares. Cut (2) 2-3/8" squares and (2) 2" squares in half diagonally once to make Side and Corner triangles respectively.
	Batting 72" x 72"

ADDITIONAL REQUIREMENTS

Thread to match fabrics

Basic sewing supplies

Template plastic

Sewing machine

Rotary cutter, ruler and mat

STAR SQUARE BLOCKS

Note: Measure and mark the end of the seamline at the side corner on the wrong side, if necessary, to ensure accuracy when sewing the diamonds together.

1. Sew (1) **K** diamond to (1) **D** diamond reversed along one long edge beginning at the center point and ending at the side corner of the seamline to make a diamond pair. Make 4.

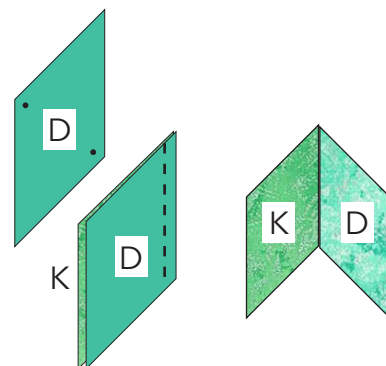

2. Sew (1) **K** diamond of the diamond pair to (1) **N** 3-3/8" square ending at the corner of the seamline.

3. Sew (1) **D** diamond reversed to adjacent side of **N** 3-3/8" square beginning at the corner of the seamline diamond pair units. Make 4.

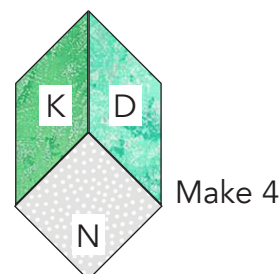
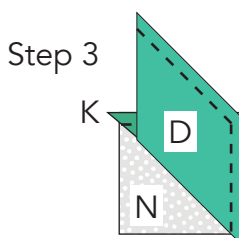
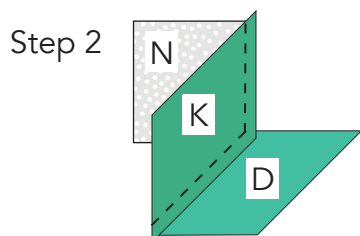

SHIMMERING STARS

4. Sew (2) **D/K** diamond pair units together along the side of the diamond ending at the corners of the seamline. Make 2.
5. Following steps 2-3, sew sides of diamonds to (1) **N** Large Triangle to make half star units. Make 2.
6. Sew (2) half star units together along the sides of the diamonds beginning and ending at the corners of the seamline.
7. Following steps 2-3, sew sides of diamonds to (2) **N** Large Triangles to make star center. Make 1.

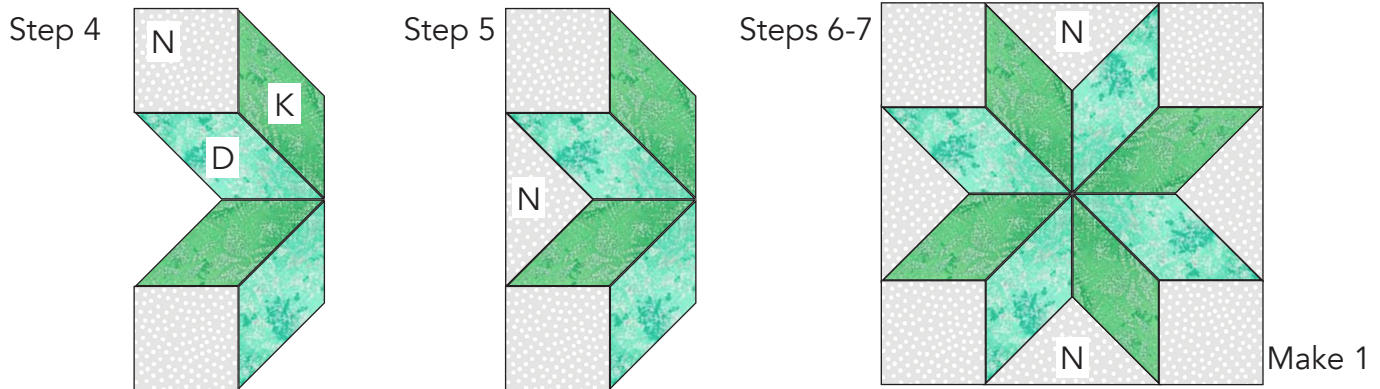

8. Draw a diagonal line on the wrong side of (16) **G** 3-3/8" squares.
9. Place (1) **G** 3-3/8" square on (1) **C** 3-3/8" square. Sew 1/4" on each side of the line. Make 4. Cut along the drawn line to make (2) **C/G** triangle pairs. Make 8.
10. Repeat step 9 using (1) **G** 3-3/8" square and (1) **J** 3-3/8" square to make **J/G** triangle pairs. Make 8.

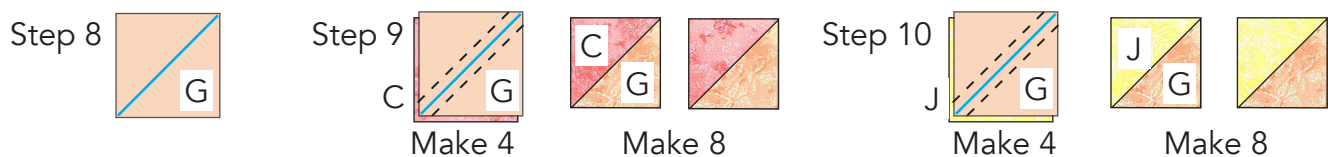

11. Sew (1) **I** Small Triangle to the side of (1) **C/G** triangle pair as shown. Sew (1) **B** Small Triangle to the opposite side to make triangle unit 1. Make 2.
12. Sew (1) **H** Small Triangle to the side of (1) **J/G** triangle pair as shown. Sew (1) **B** Small Triangle to the opposite side of (1) **J/G** triangle pair to make triangle unit 2. Make 1 each.
13. Sew together (2) triangle unit 1 alternating with (2) triangle unit 2 as shown. Sew (1) **I** Small Triangle to the end to complete a border unit 1. Make 2.

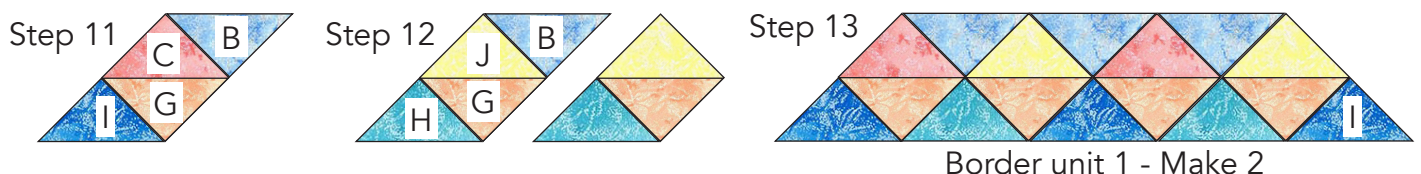

SHIMMERING STARS

14. Following steps 10-14, make border unit 2 reversing the **H** and **I** triangles to make border unit 2.

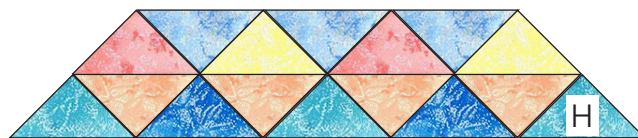
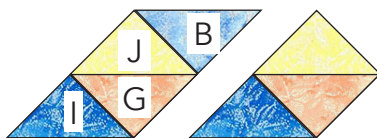
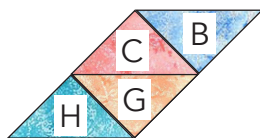

Make 2

15. Sew (2) border units 1 to top and bottom of center star unit beginning and ending stitching 1/4" from ends of seamline.

16. Sew (2) border units 2 to sides of center star unit beginning and ending stitching 1/4" from ends of seamline.

17. Sew diagonal ends of border units 1 and 2 together to make Star Square Block 1.

Star Square Block 1

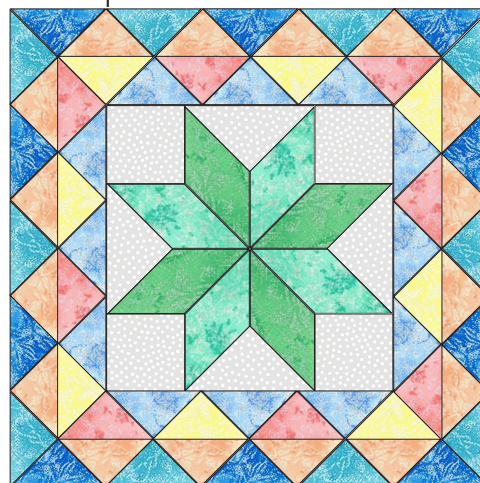

Make 2

18. Following steps 1-17, make Star Square Block 2 using the color combinations for the units shown below. Make 2.

Star Center

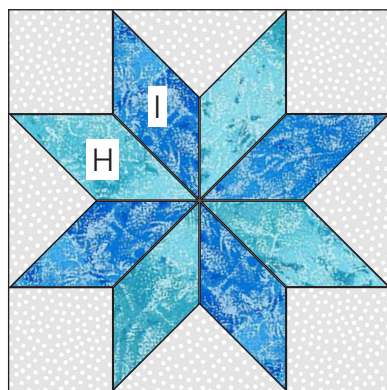

Make 1

Border Unit 1



Make 2 each

Border Unit 2



Star Square Block 2

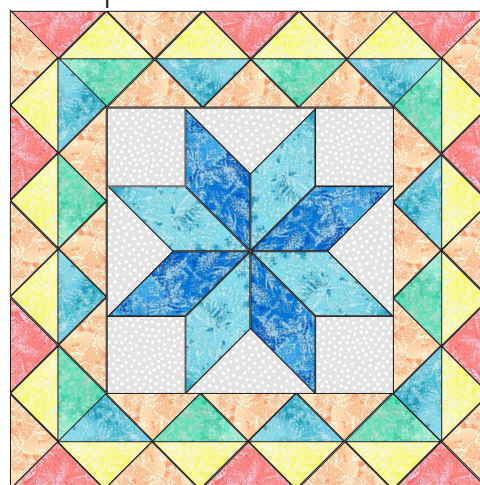

Make 2

Triangle Pairs



Make 8 each

SHIMMERING STARS

STAR TRIANGLE BLOCKS

19. Following steps 1-3, make (1) diamond pair unit using (1) **F** Diamond reversed and (1) **E** Diamond.

20. Sew (1) **F** Diamond reversed and (1) **E** Diamond to diamond pair beginning at the center point and ending at the side corner of the seamline.

21. Following steps 2-3, sew sides of diamonds to (1) **N** Large Triangle. Sew (2) **N** Medium Triangles to remaining points of **E** and **F** Diamonds to make a star triangle block 1. Make 4.

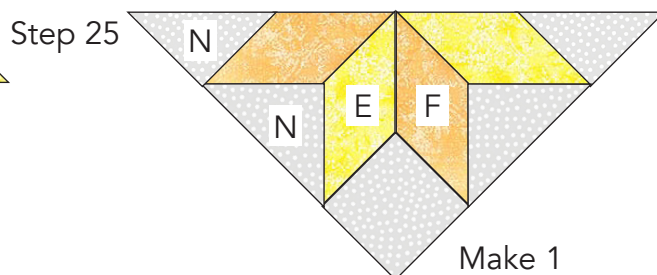
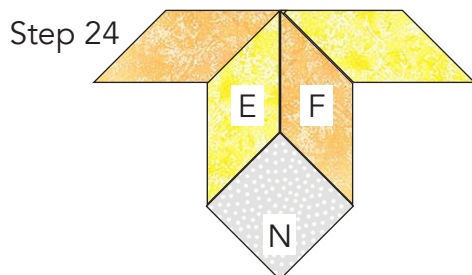

22. Following steps 8-14, make border units 1 and 2 as shown.

23. Sew (1) border unit 1 and 2 to sides of center star unit beginning and ending stitching 1/4" from ends of seamline. Sew diagonal ends of border units 1 and 2 together to make Star Triangle Block 1. Make 4

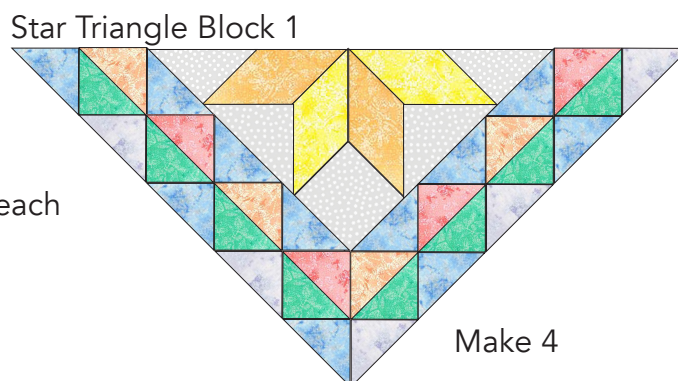
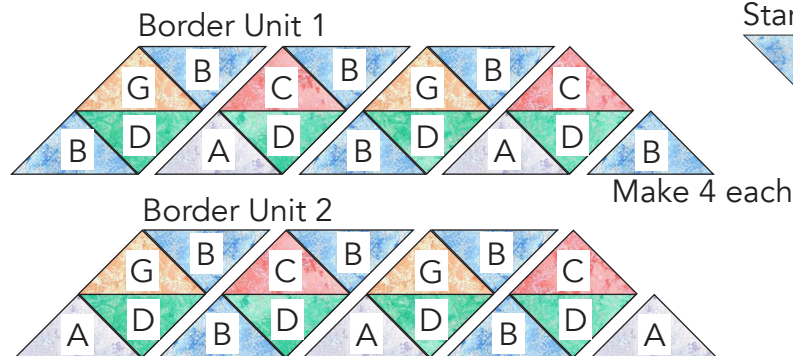

24. Following steps 19-23, make Star Triangle Block 2 as shown.

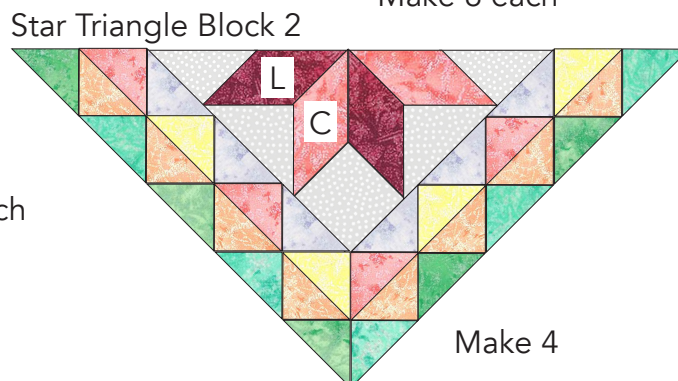
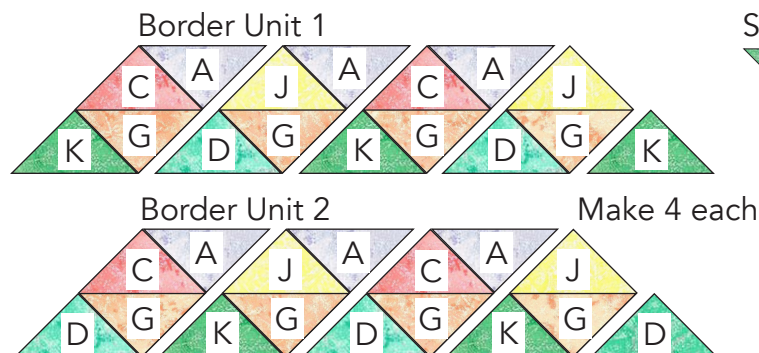
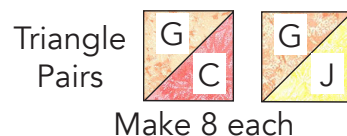



SHIMMERING STARS

QUILT ASSEMBLY

25. Following the Layout Diagram on page 8, arrange Star Square Blocks 1 and 2 and Triangle Star Blocks 1 and 2 in diagonal rows. Sew together blocks alternating with **M** 2" x 18" strips to make the block rows.

26. Sew **M** 2" x 18" strips alternating with **A** 2" squares to make the sashing rows. Sew **N** Side and Corner triangles to ends of sashing rows as shown.

27. Sew block rows and sashing rows together matching the seams. Sew (2) **N** Corner Triangles to corners of quilt.

BORDERS

28. Sew (1) **M** 4" x 53-1/2" border to each side of quilt.

29. Sew (1) **K** 4" square and (1) **C** 4" square to ends of (1) **M** 4" x 53-1/2" border. Sew (1) **H** 4" square and (1) **E** 4" square to ends of (1) **M** 4" x 53-1/2" border. Sew to top and bottom of quilt, noting position of squares.

30. Sew (1) **I** 2" x 60-1/2" border to each side of quilt. Sew (2) **I** 2" x 63-1/2" borders to top and bottom of quilt.

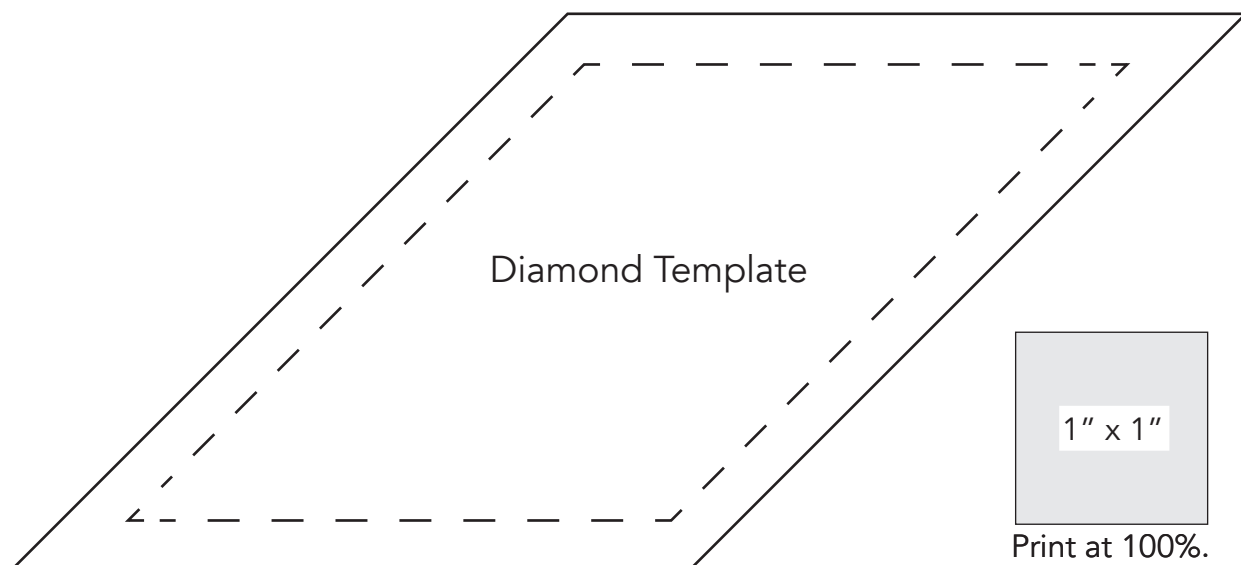

SHIMMERING STARS

QUILT LAYOUT

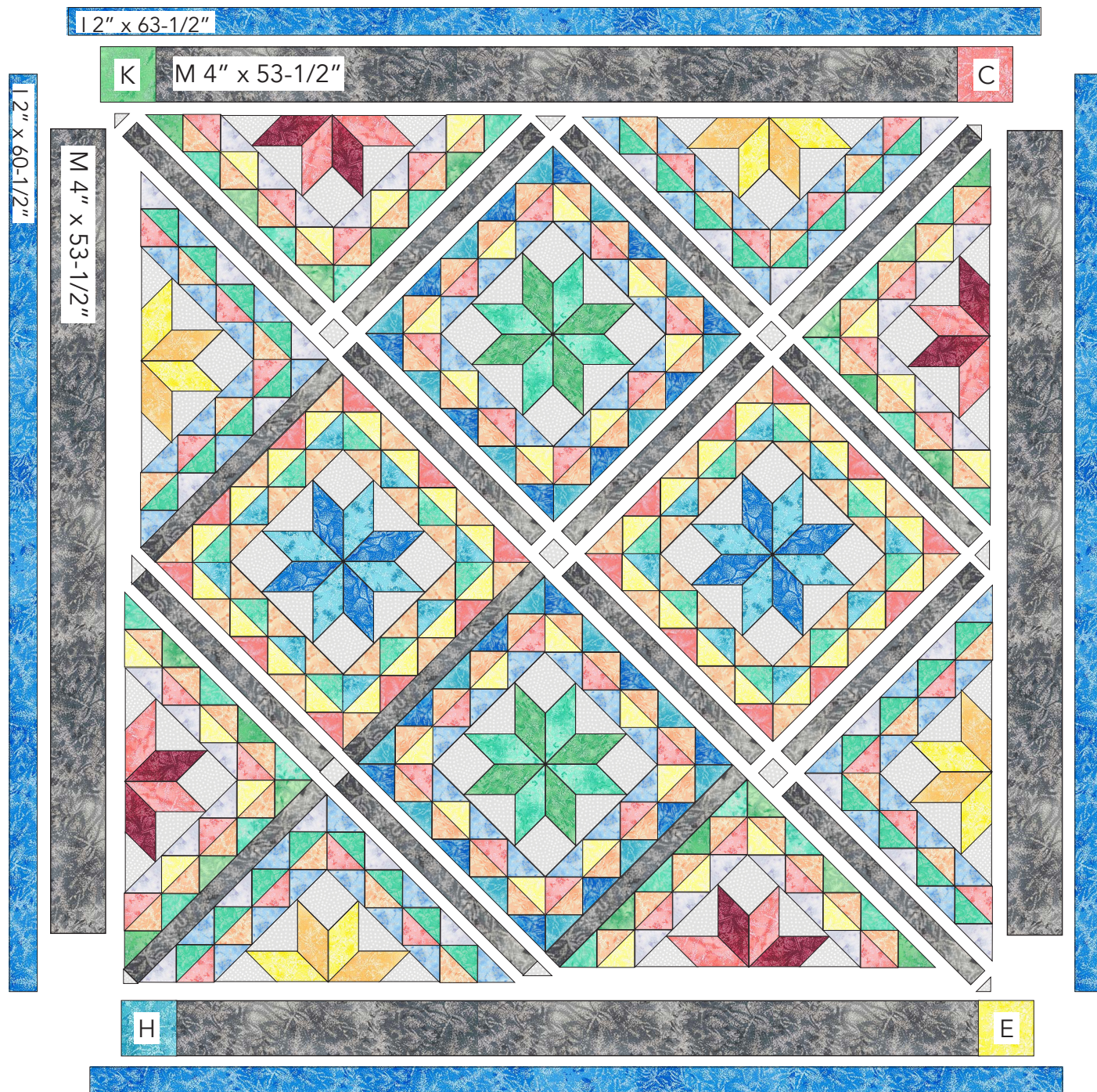

FINISHING: Layer quilt top, batting and backing together to form quilt sandwich. Baste and quilt as desired. Bind using seven fabric **L** 2-1/4" strips.