

Krystal Charm

60" x 60"

Fabric Requirements:

[1] Charm Pack (Charm0167)

2 yards Background (Krystal 1007 Alabaster)

2 yards Blocks & Binding (Krystal 1302 Coal)

4 yards Backing



Krystal Charm

60" x 60"

Cutting:

WOF = Width of Fabric

From Krystal 1007 Alabaster (background):

Cut [3] 8-1/2" x WOF strips; subcut [15] 7-1/2" x 8-1/2" rectangles

Cut [2] 7-1/2" x WOF strips; subcut [16] 3" x 7-1/2" rectangles and [1] 7-1/2" x 8-1/2" rectangle

Cut [2] 5" x WOF strips; subcut [16] 5" squares

Cut [2] 3" x WOF strips; subcut [16] 3" x 5" rectangles

Cut [4] 1-1/2" x WOF strips; subcut [8] 1-1/2" x 15-1/2" rectangles

From Krystal 1302 Coal (accent):

Cut [4] 7-1/2" x WOF strips; from 2 strips, subcut [16] 3" x 7-1/2" rectangles
from remaining strips, subcut [16] 4" x 7-1/2" rectangles

Cut [4] 3" x WOF strips; subcut [32] 3" x 5" rectangles

Cut [7] 2-1/2" x WOF strips (binding)

Piecing:

Sew a 3" x 5" background rectangle to a 5" charm square. Press toward charm square.
Repeat to make a total of [16] units.

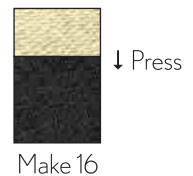

Sew a 3" x 7-1/2" background rectangle to each unit, as shown.
Press toward background rectangle.

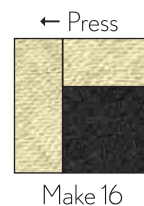

Sew a 7-1/2" x 8-1/2" background rectangle to opposite side of each unit.
Press toward large rectangle.

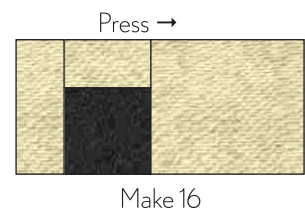

Sew a pieced unit to each side of a 1-1/2" x 15-1/2" background rectangle. Press toward pieced units. Make 8.

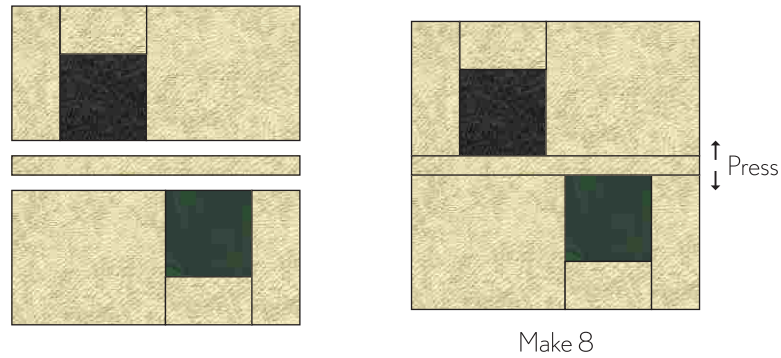

Sew a 3" x 5" accent rectangle to a 5" charm square. Press toward accent rectangle. Sew a 3" x 7-1/2" accent rectangle to each unit, as shown. Press toward accent rectangle. Repeat to make a total of [16] units.



Sew a 3" x 5" accent rectangle to a 5" background square. Press toward accent rectangle. Sew a 4" x 7-1/2" accent rectangle to side of each unit. Press toward accent rectangle. Repeat to make a total of [16] units.



Sew a charm square unit to a background square unit as shown and press. Make 16.



Sew a pieced unit to each side of a 1-1/2" x 15-1/2" accent rectangle. Press toward accent rectangle. Make 8.

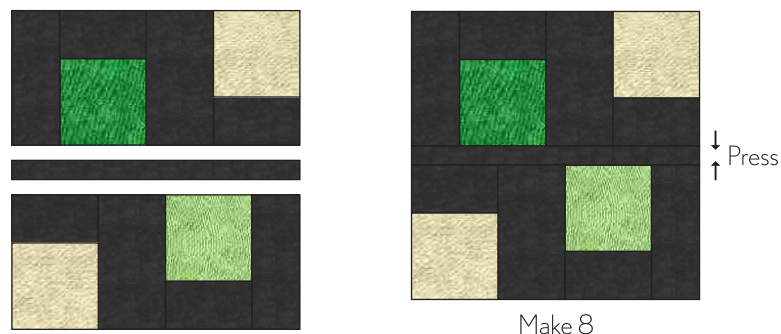

Arrange blocks as shown below. Sew together into horizontal rows. Sew rows together to complete quilt top.

