

LUCY

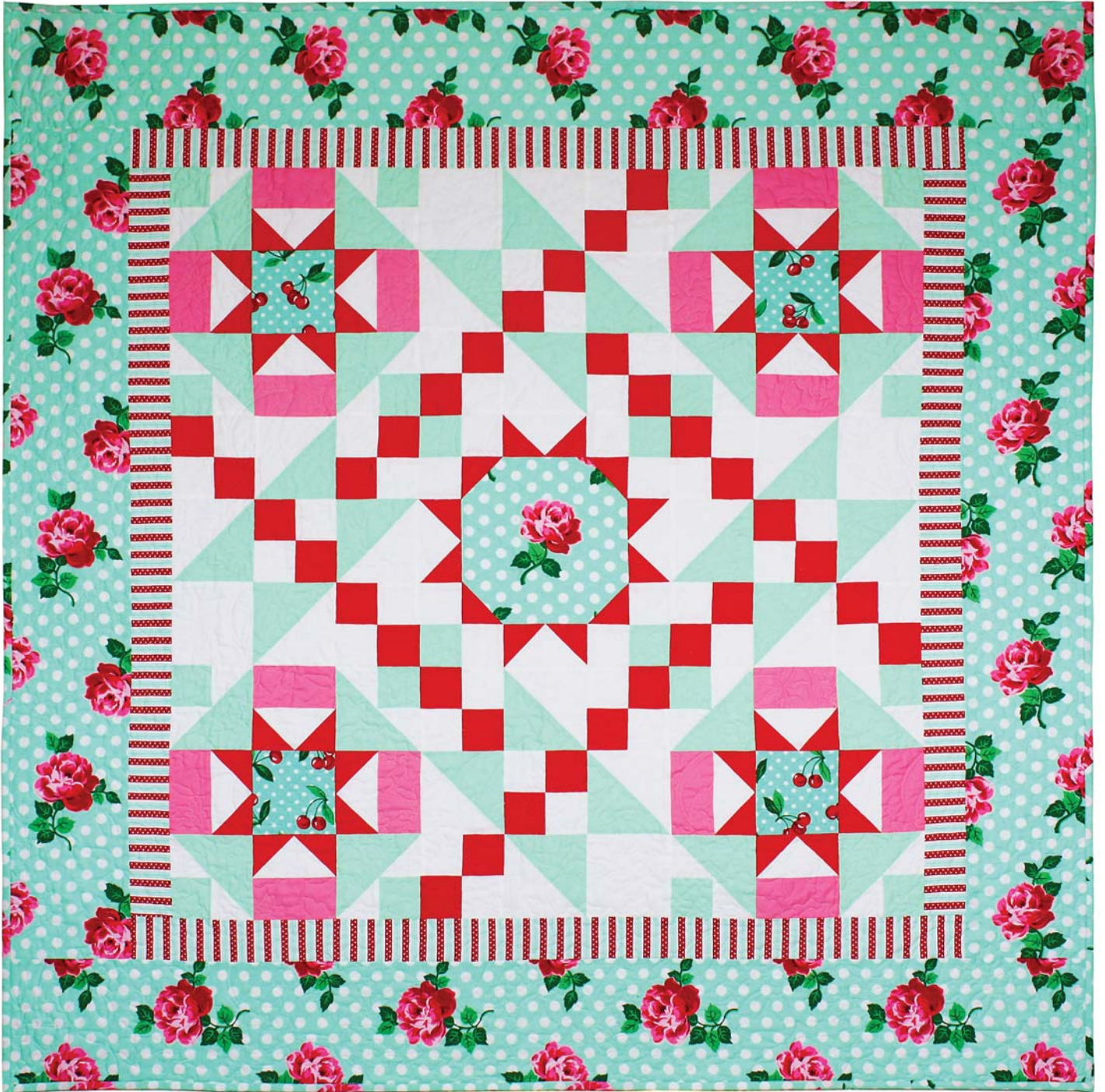

michael miller FABRICS

SIZE: 52" W X 52" H | QUILT BY SWIRLY GIRL DESIGNS | LEVEL: ADVANCED BEGINNER

© Swirly Girls Design, Inc. Permission is granted to shop owners and teachers to make copies for promotional or educational purposes.
This pattern may not be reproduced for commercial purposes.

FABRIC REQUIREMENTS



CX6852_AQUA
LUCY
1 3/4 YARDS



CX6561_MINT
CHERRY DOT
1/4 YARD



CX6855_AQUA
NORMA
1/3 YARD



SC5333_MIST
COTTON COUTURE
1/2 YARD



SC5333_BRIGHT WHITE
COTTON COUTURE
7/8 YARD



SC5333_BUBBLEGUM
COTTON COUTURE
1/4 YARD



SC5333_WATERMELON
COTTON COUTURE
3/8 YARD



CX6708_MINT
HEART O MINE
4 YARDS (BACKING)

Lucy

by Swirly Girls Design

Cutting:

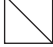
WOF = Width of Fabric Once Diagonally = 

From CX6852 Lucy Aqua, cut:

[1] 8-1/2" x WOF strip; subcut [1] 8-1/2" square

[5] 6-1/2" x WOF strips (border)

[6] 2-1/2" x WOF strips (binding)

From CX6561 Cherry Dot Mint, cut:

[1] 4-1/2" x WOF strip; subcut [4] 4-1/2" squares

From SC5333 Cotton Couture Bright White, cut:

[1] 4-7/8" x WOF strip; subcut [8] 4-7/8" squares and cut once diagonally

[2] 4-1/2" x WOF strips; subcut [20] 2-1/2" x 4-1/2" rectangles and [4] 4-1/2" squares

[2] 2-7/8" x WOF strips; subcut [16] 2-7/8" squares and cut once diagonally and [8] 2-1/2" squares

[2] 2-1/2" x WOF strips

From SC5333 Cotton Couture Watermelon, cut:

[5] 2-1/2" x WOF strips; from [3] strips, subcut [44] 2-1/2" squares (set remaining [2] strips aside)

From SC5333 Cotton Couture Bubblegum, cut:

[1] 4-1/2" x WOF strip; subcut [16] 2-1/2" x 4-1/2" rectangles

From SC5333 Cotton Couture Mist, cut:

[2] 4-7/8" x WOF strips; subcut [16] 4-7/8" squares and cut once diagonally

[2] 2-1/2" x WOF strips; subcut [20] 2-1/2" squares

From CX6855 Norma Aqua, cut:

[4] 2-1/2" x WOF strip; subcut [2] 2-1/2" x 40-1/2" inner borders and [2] 2-1/2" x 36-1/2" inner borders

Piecing:

Draw a diagonal line from corner to corner on the wrong side of [44] 2-1/2" Watermelon squares. With right sides together, place a 2-1/2" Watermelon square on the left side of a 2-1/2" x 4-1/2" Bright White rectangle and stitch diagonally on the drawn line (see diagram below). Trim 1/4" from stitching line and press toward Watermelon. Place a second 2-1/2" Watermelon square on right side of unit, stitch, trim and press. Repeat to make a total of [20] flying geese units. (You will have [4] 2-1/2" Watermelon squares left over for center block).

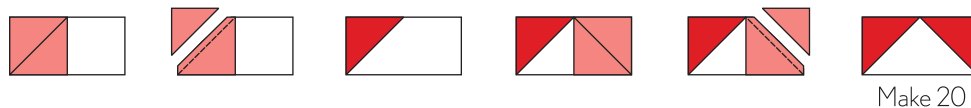

Place a 2-1/2" Watermelon square on the corner of the 8-1/2" Aqua square. Sew on drawn line and trim 1/4" from seam. Repeat on remaining three corners. Make 1.

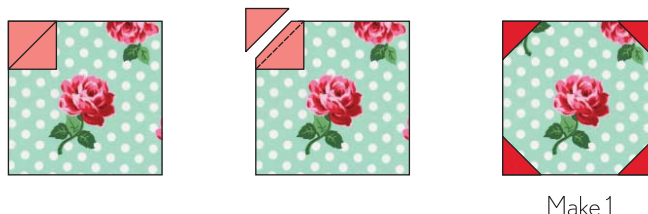

Sew a 2-1/2" Bright White square to each side of a flying geese unit. Press toward square. Make 2. Sew each unit to the side of 8-1/2" Aqua square. Press toward 8-1/2" Aqua square.

Sew a 2-1/2" Mist square and a 2-1/2" Bright White square to each side of a flying geese unit as shown. Press toward squares. Make 2. Sew one unit to top and one unit to bottom of block. Press toward flying geese unit. Block should measure 12-1/2" square.

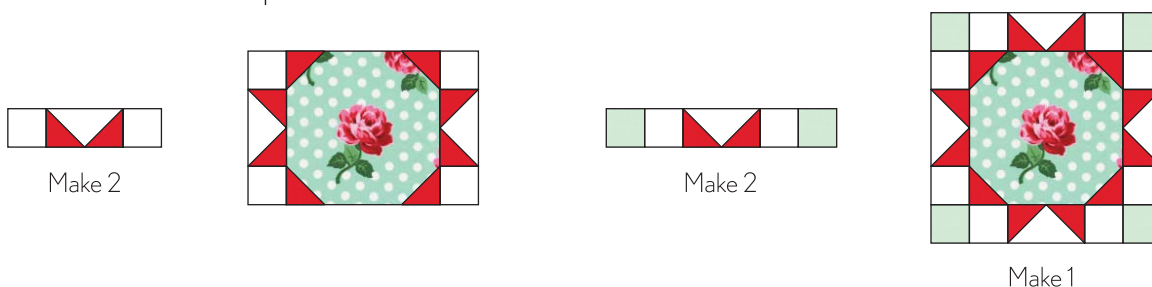

Sew a 2-1/2" x 4-1/2" Bubblegum rectangle to a flying geese unit as shown. Press toward Bubblegum rectangle. Repeat to make a total of [16] units.

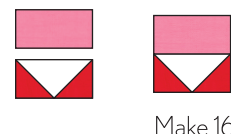

Sew a small Bright White triangle to the left side of a 2-1/2" Mist square as shown. Press toward triangle. Add a small Bright White triangle to the bottom of unit as shown. Press toward triangle. Sew a large Mist triangle to unit as shown. Press toward Mist triangle. Repeat to make a total of [16] units.

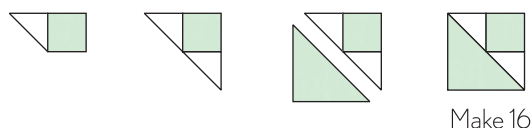

Referring to diagram below, lay out all units to form block. Sew units together into rows. Press as indicated by arrows. Sew rows together and press to finish block. Make [4] star blocks.

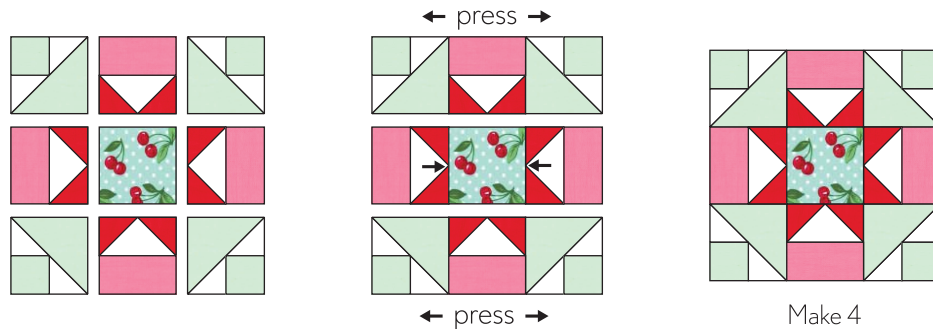

Sew a 2-1/2" Bright White strip lengthwise to a 2-1/2" Watermelon strip. Press toward Watermelon. Make [2] strip sets. Crosscut [32] 2-1/2" sections from strip sets.

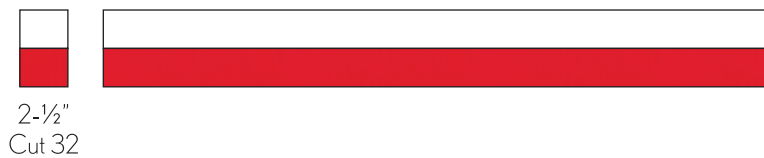

Sew [2] units together to form a four-patch. Press seam open. Repeat to make a total of [16].



Draw a diagonal line on the wrong side of [8] 5" Bright White squares. With right sides together, place a 5" Bright White square on a 5" Mist square. Stitch 1/4" on each side of line. Cut along drawn line and press toward Mist. Trim half-square triangle unit to measure 4-1/2" square. Make [16].

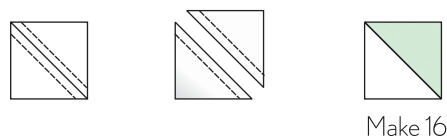

Referring to diagram below, lay out all units to form block. Sew units together into rows. Press as indicated by arrows. Sew rows together and press seams open to complete block. Make [4] chain blocks.

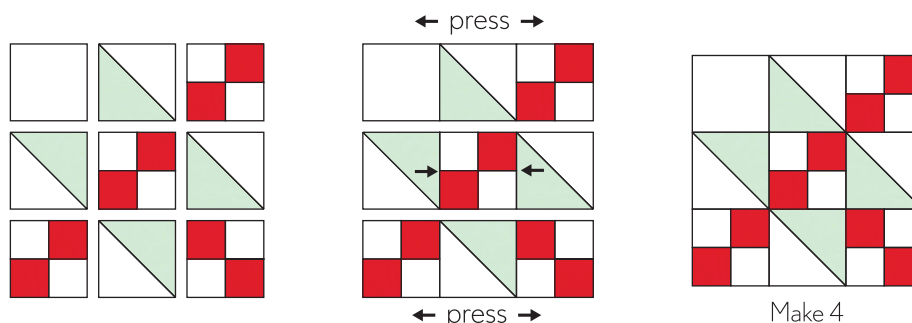

Referring to diagram below, lay out all blocks. Make sure you have the chain blocks turned in the correct direction. Sew blocks together into horizontal rows. Press seams open. Sew rows together and press to complete quilt center.

Sew a 2-1/2" x 36-1/2" inner border strip to each side of quilt center. Press toward border. Sew a 2-1/2" x 40-1/2" inner border strip to top and bottom of quilt center. Press toward border.

Sew [5] 6-1/2" Lucy Aqua border strips together end to end. Cut [2] borders 40-1/2" long and sew to sides of quilt. Press toward borders. Cut [2] borders 53-1/2" long and sew to top and bottom of quilt. Press toward borders to complete quilt top.

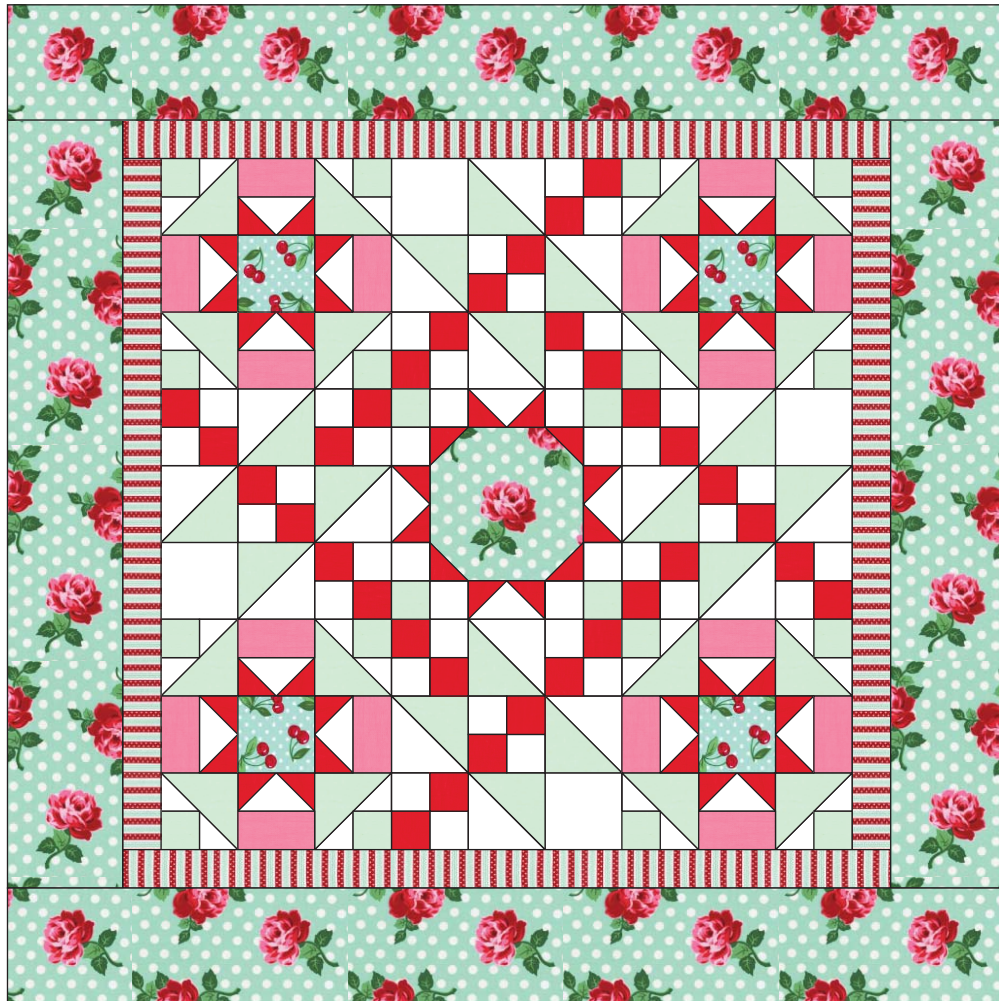

www.swirlygirlsdesign.com