

Zen Garden

Zen Garden

Designed by Marinda Stewart

Quilted by Ronda Beyer

Finished Quilt approximately 49½" x 48½"

CX2823 Carp col. Black	⅝ yard
CX1087 Marble col. Sienna	⅝ yard
Krystal 1003 Beige	¾ yard
Krystal 1002 Ecru	½ yard
Krystal 2052 Sage green (binding)	¾ yard
Krystal 1150 Pale celery	¾ yard
Krystal 2112 Light rust	⅛ yard
Krystal 1008 Pale tan, 1082 pale gray	fat quarter each
Krystal 1156 Leaf green	11" x 11" square
Krystal 2053 Yellow green	11" x 11" square
Krystal 2153 Dark green	7" x 7" square
Krystal 1083 Medium gray	9" x 14" rectangle
Krystal 2285 Dark Gray	5" x 5" square
Backing	60" x 60"
Batting	60" x 60"
Fusible Web	
Thread to match fabrics for appliqué	

Disclaimers

1. This pattern is provided as a courtesy to quilt stores, catalogs, and quilters. Michael Miller Fabrics, LLC is NOT responsible for the accuracy of any kits packaged to accompany this pattern. Please direct any inquiries to the kit maker.
2. Yardage requirements for this pattern may allow for excess yardage to accommodate specific placement of motifs or to allow for any fussy-cutting to achieve the finished quilt design.
3. While every attempt has been made to give accurate measurements, yardage requirements and construction directions, this does not allow for personal variations in measuring, cutting and/or sewing. The enclosed directions were used in the construction of the original quilt.

1. From CX2823, cut 1 piece 21" high x 34" wide. From CX1087, cut 2 strips 4½" x 21". Stitch to the sides of the panel. From CX1087, cut 2 strips 4½" x 42". Stitch to the top and bottom of the panel.

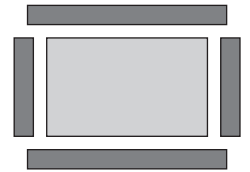

2. From Krystal 1008, cut 1 piece 2½" x 22". On the left edge at the top, measure down 2". Cut a diagonal line from the mark to the upper right corner.

From Krystal 1003, cut 1 piece 2½" x 10". Measure up 2" on the lower right edge. Trim as above and join the 2 pieces along the diagonal edges. Trim strip to 29" long, then stitch to the right edge of the panel.

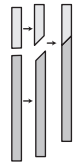

5. From Krystal 1003, cut 1 strip 6½" x 44½". Sew to the top of the panel.

6. From Krystal 1008 cut 1 strip 5½" x 19". Measure 9" in from lower left corner. Mark, then trim from mark to upper left corner.

From Krystal 1150, cut 1 strip 5½" x 34". Measure 9" in from upper right corner. Trim from mark to lower left corner. Join strips along the diagonal edges. Trim strip to 44" then stitch to the bottom of the panel.

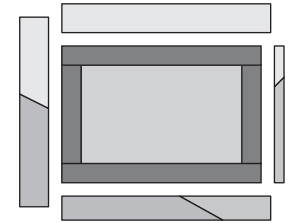

7. From Krystal 1150, cut 1 strip 6½" x 24". Measure 3" down from upper right corner. Trim as before.

From Krystal 1003, cut 1 piece 6½" x 21". Measure 3" up from lower left corner. Trim and join strips along the diagonal edges. Trim strip to 40" then stitch to the left side of the panel. Set panel aside.

8. From Krystal 1002, cut 2 strips 9½" x width of fabric. Piece strips along the short end.

Cut 1" wide strips on the bias from Krystal 1003. Piece together along the short ends to make approximately 205". Fold under ¼" on each side and press to make ½" finished bias strip.

Arrange bias in matching serpentine lines on Krystal 1002, referring to the photograph, if necessary. Top stitch the bias strips in place. Trim section to measure 9½" x 50", then stitch to the top of the panel.

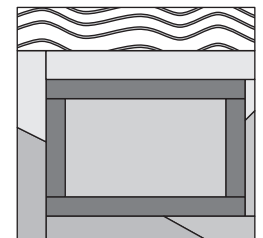

9. From Krystal 1082, cut 1 piece 6½" x 20½". From Krystal 2112, cut 2 strips 2" x 20½". Stitch to the sides of the gray rectangle. From Krystal 2112, cut 2 strips 2" x 9½". Stitch to top and bottom of rectangle.

Transfer the calligraphy designs to the center of the gray panel. Fill in the outlines using a permanent textile pen, following the manufacturer's directions.

Turn under ¼" seam allowance on all sides of the calligraphy panel. Place on quilt referring to the photograph, if necessary, and topstitch in place. Cut excess fabric from behind panel, if desired, to eliminate bulk.



10. Following manufacturer's directions iron fusible web to the back of each Krystal 1082, 1083, and 2285 (grays), and Krystal 1156, 2053, and 2153 (greens.)

Using rock templates and gray fabrics, make 1 large rock, 1 medium rock, and 7 small rocks. Place on quilt and satin stitch appliqué in place.

Using cutting diagram, cut bias slivers from each of the 3 green Krystals. The bias cut will allow the leaves to be shaped easily. Arrange one cluster of leaves in the lower left corner of the quilt. Arrange additional leaves on each side of the calligraphy panel. Satin stitch appliqué in place.

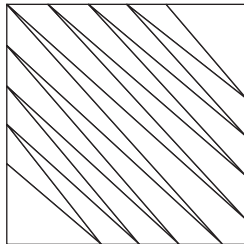

11. Layer, quilt, and bind. Cut binding strips 2½" wide from Krystal 2052.

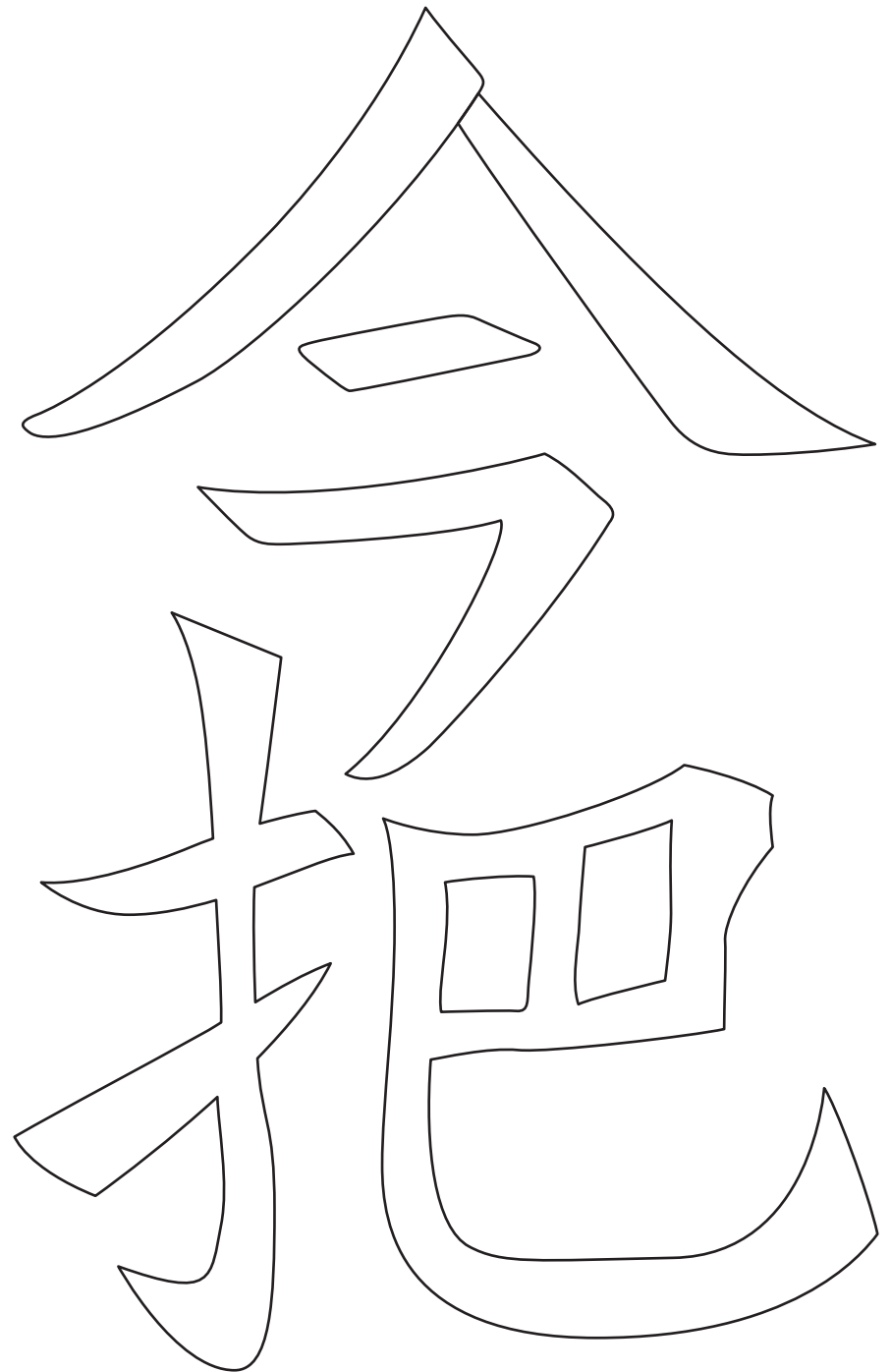
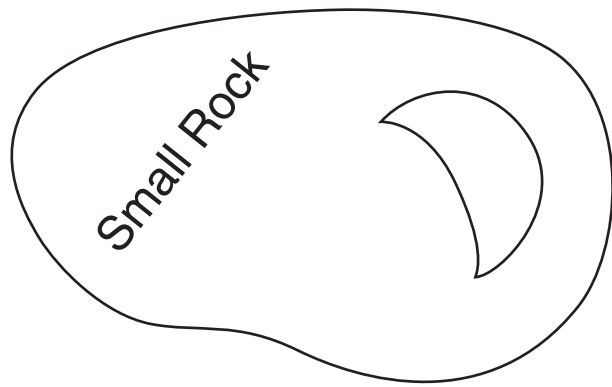

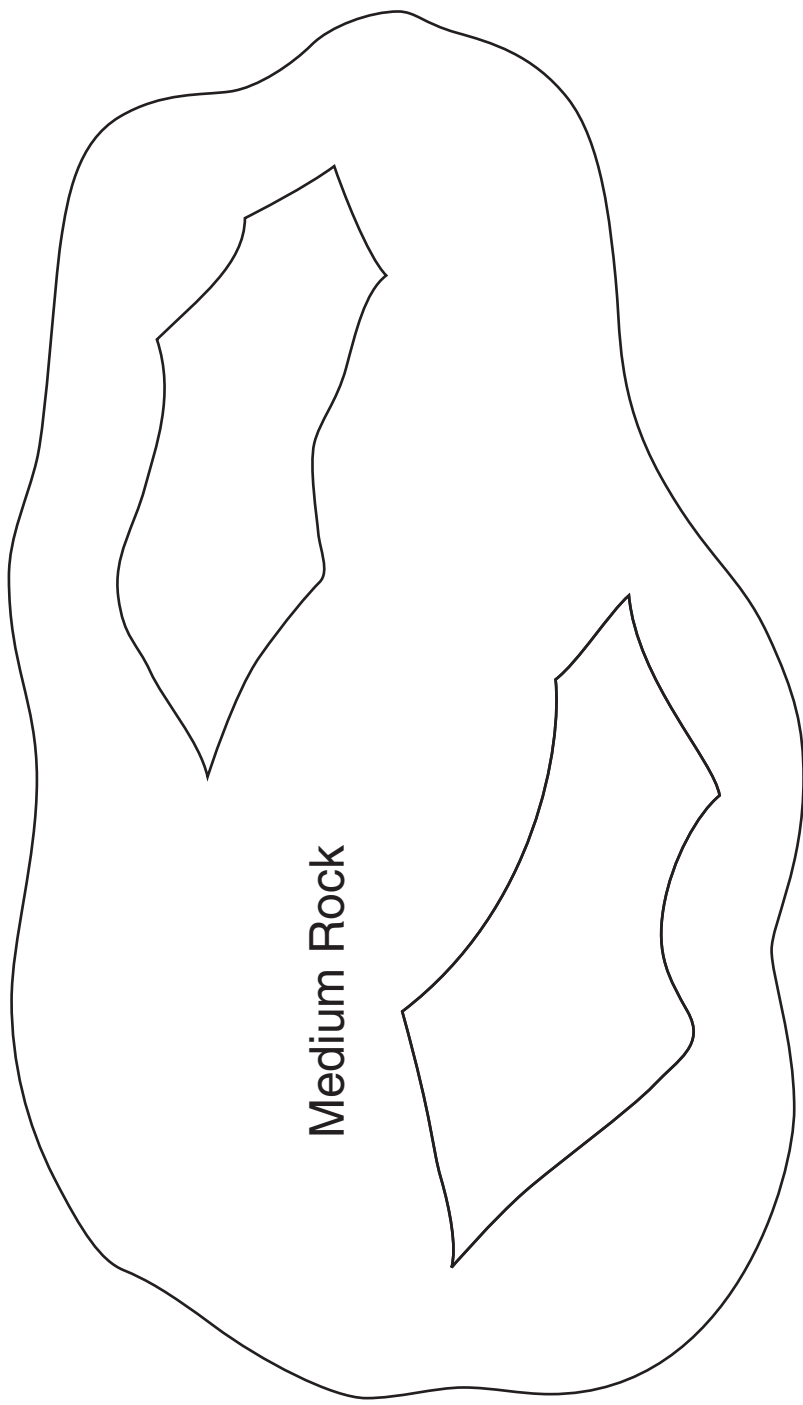

Medium Rock



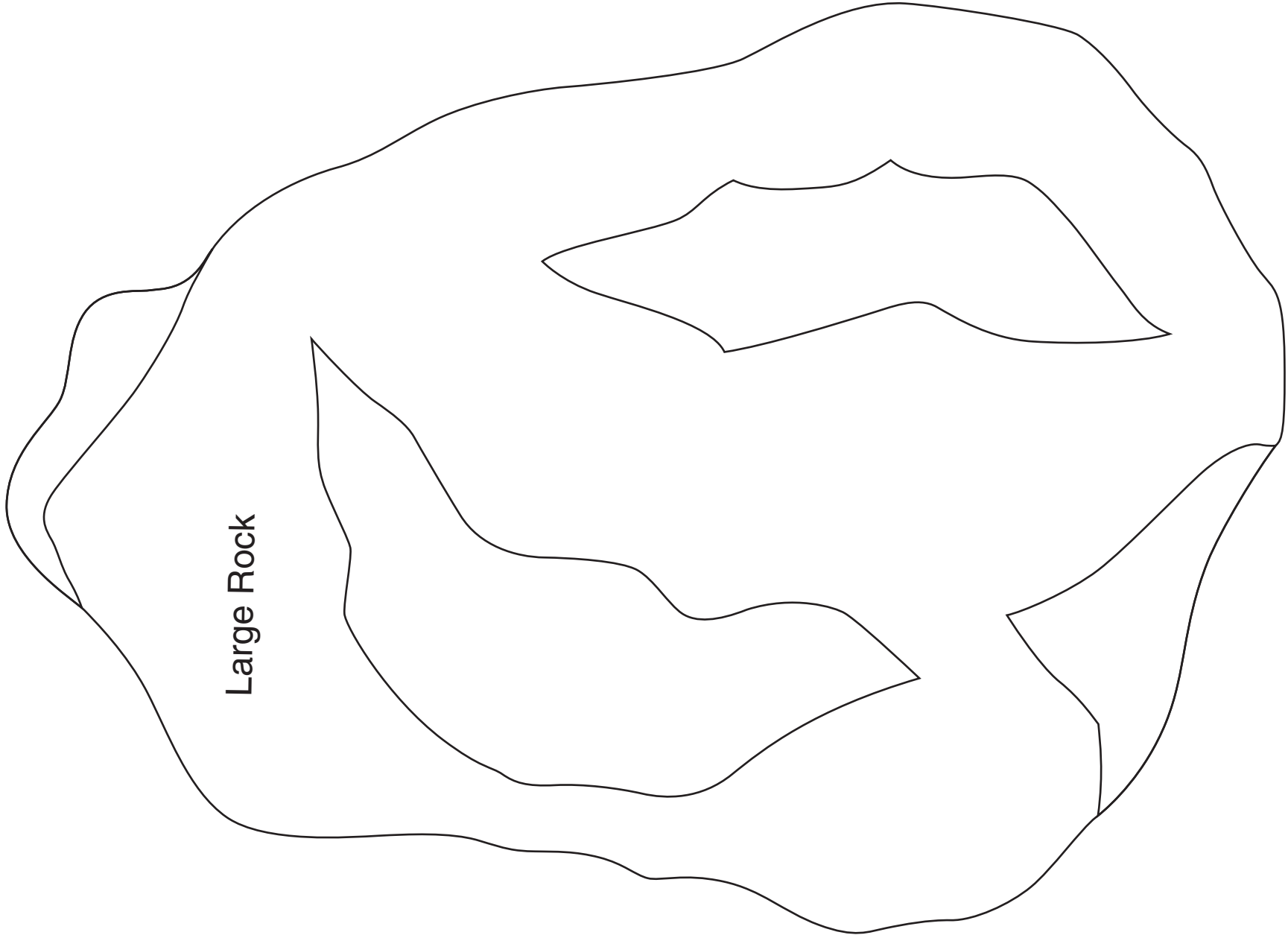

Large Rock