

# Jungle Parrots

by Marinda Stewart

Finished Quilt approximately 48" x 48"

CX2960 Jungle Parrots col. Multi	1½ yards
CM2981 Colorful Dragonfly col. Blue	½ yard
CM2978 Midnight Dragonfly col. Blue	¼ yard
CM2980 Colorful Bamboo col. Multi (includes binding)	1 yard
CX274 Giddy Dot col. Yellow	½ yard
CX274 Giddy Dot col. Pink	⅛ yard
CX1190 Vine Hearts col. Clementine	¼ yard
CM2982 Inspirational Tulips col. Pink	¼ yard
CX2588 Dot Wash col. Pink	⅛ yard
CX1190 Vine Hearts col. Raspberry	⅛ yard
CX2801 Scroll Swirls col. Yellow	⅛ yard
CM2977 Inspirational Floral col. Yellow, Pink	⅛ yard each
Backing	3 yards
Batting	58" x 68"
Fusible web	
Threads to match fabric for appliqué	

## Disclaimers

1. This pattern is provided as a courtesy to quilt stores, catalogs, and quilters. Michael Miller Fabrics, LLC is NOT responsible for the accuracy of any kits packaged to accompany this pattern. Please direct any inquiries to the kit maker.
2. Yardage requirements for this pattern may allow for excess yardage to accommodate specific placement of motifs or to allow for any fussy-cutting to achieve the finished quilt design.
3. While every attempt has been made to give accurate measurements, yardage requirements and construction directions, this does not allow for personal variations in measuring, cutting and/or sewing. The enclosed directions were used in the construction of the original quilt.

# Jungle Parrots

## Directions

1. From CX2960 Jungle Parrots Multi, cut 2 horizontal pieces 6" x width of fabric. Cut two vertical pieces 6" x 37½". Set border strips aside.
2. From CX274 Giddy Dot Yellow, cut thirteen squares 5½" x 5½". Following manufacturer's directions, iron fusible web onto wrong side of remaining CX2960 Jungle Parrots Multi. Fussy-cut 9 assorted parrots and leaves. Fuse in place on each Giddy Dot Yellow square (refer to photo.) Satin stitch appliqué raw edges to finish.
3. From CX2588 Dot Wash Pink, 4 strips cut ⅞" x width of fabric. Cross-cut 6 strips ⅞" x 5½"; cross-cut 4 strips ⅞" x 16"; cross-cut 2 strips ⅞" x 16½".

Stitch one ⅞" x 5½" Dot Wash strips to the bottom of 6 squares from step 2. Join three blocks together to make one row. (Keep all parrots upright.) Make three rows. Stitch ⅞" x 16½" strips between the rows and to the left and right sides of the unit. Stitch ⅞" x 17" strips to the top and bottom of the unit.

From CM2980 Colorful Bamboo Multi, cut 2 strips 1¼" x width of fabric. Cross-cut into 2 strips 1¼" x 17" and stitch to the sides of the unit. Cross-cut 2 strips 1¼" x 18½" and stitch to the top and bottom.

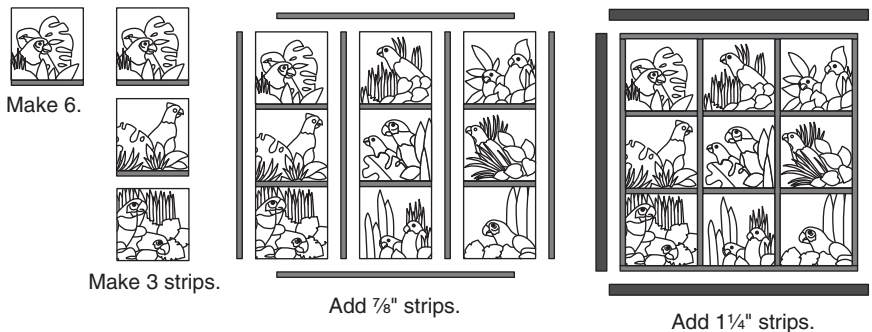

4. From CX1190 Vine Hearts Clementine, cut 14 squares 3½" x 3½". From CM2982 Inspirational Tulips Pink, cut 14 squares 3½" x 3½".

For top and bottom of center, sew together three of each fabric, alternating fabrics. For sides, sew together four of each fabric, alternating fabrics. Sew top and bottom and each side row to the quilt, maintaining the the pattern of alternating fabrics.

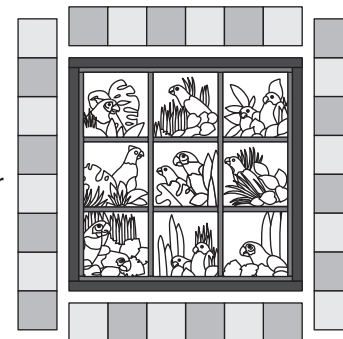

- From CM2978 Midnight Dragonfly Blue, cut 4 strips 1½" x width of fabric. Cross-cut 2 strips 1½" x 24½". Stitch to the sides of the quilt. Cross-cut 2 strips 1½" x 26½". Stitch to the top and bottom of quilt.
- Cut all squares 2⅞" x 2⅞": From CX2801 Scroll Swirls Yellow, cut 10. From CX274 Giddy Dot Yellow, cut 18. From CX1190 Vine Hearts Raspberry, cut 9. From CM2977 Inspirational Floral Pink, cut 8. From CX274 Giddy Dot Pink, cut 11.

Draw line diagonally across all yellow squares. Pair yellow squares with pink squares, right sides together: Pair CX2801 with CX274, CX274 with CX1190, CX1190 with CM2977. Stitch ¼" on each side of the drawn line. Cut on drawn line, snip small triangles off that stick out, then press seams toward pinks. Refer to quilt photo, or randomly place half square triangles into 4 rows – two rows with 13 triangles each and 2 rows with 15 triangles each. Stitch the rows of 13 to the top and bottom of the quilt. All triangles are facing in the same direction. Stitch the strips of 15 triangles to the sides of the quilt. All triangles are facing in the same direction. Refer to photo.

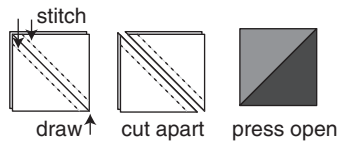

- From CM2981 Colorful Dragonfly Blue, cut 4 strips 3½" x width of fabric. Recut 2 strips to 3½" x 30½". Stitch to the sides of the quilt. Recut remaining 2 strips to 3½" x 36½". Stitch to the top and bottom of the quilt.
- From CM2980 Colorful Bamboo Multi, cut 4 strips 1" x width of fabric. Recut 2 strips to 1" x 36½" and stitch to the sides of the quilt. Recut 2 strips to 1" x 37½" and stitch to the top and bottom of the quilt.
- Recut the 6" strips of CX2960 Jungle Parrots to 6" x 37½". Stitch to the top and bottom of the quilt. NOTE: This is a one-way design fabric – keep parrots upright.
- From CM2980 Colorful Bamboo Multi, cut four 1" x 5½" strips. Sew a strip to the top of two 5½" x 5½" Jungle Parrot squares (for bottom corner parrots) and to the bottom of the two remaining blocks (for top corner parrots).



Top left.



Top right.



Bottom left.



Bottom right.

From CM2980, cut four 1" x 6" strips. Sew strips to the right side of each top left corner parrot and bottom left corner parrot. Sew strips to the left side of each right top corner parrot and bottom right corner parrot.

- Sew a top and bottom corner parrot block to each remaining CX2960 Jungle Parrot strip. Sew each strip to the left or right side of the quilt. Refer to quilt photograph for correct corner parrot placement.
- Layer, quilt and bind. From CM2980 Colorful Bamboo Multi cut binding strips 2½" wide. Piece together to get one continuous strip of binding. Press in half lengthwise with wrong sides together. Stitch to the right side of the quilt top, fold to the back, and hand or machine stitch in place.

