

Butterfly Kimono

by Marinda Stewart

Finished Quilt approximately 49½" x 49½"

CM2820 Tide col. Turq	1⅛ yard
CM2791 Flower Cart Panel col. Cream	1¾ yard*
CX2792 Flower Festival col. Green	⅝ yard**
CM2526 Flower Cart col. Red	⅝ yard**
CM2795 Festival Blossoms col. Red	⅜ yard
CM2781 Tiny Check col. White	fat quarter
CX2868 Embellished Butterfly col. Black	fat quarter
CM2821 Asian Maple col. Brown	¼ yard
CX2793 Festival Background col. Red	⅙ yard
CM1713 Maui Bliss col. Red	⅙ yard
CX2425 River Crane col. Purple	⅙ yard
CX2793 Festival Background col. Green (binding)	½ yard
Backing	3 yards
Batting	55" x 55"
Threads to match fabric	
Fusible web	

*Necessary amount to yield a complete design including all of the flower cart.

** One way design.

Disclaimers

1. This pattern is provided as a courtesy to quilt stores, catalogs, and quilters. Michael Miller Fabrics, LLC is NOT responsible for the accuracy of any kits packaged to accompany this pattern. Please direct any inquiries to the kit maker.
2. Yardage requirements for this pattern may allow for excess yardage to accommodate specific placement of motifs or to allow for any fussy-cutting to achieve the finished quilt design.
3. While every attempt has been made to give accurate measurements, yardage requirements and construction directions, this does not allow for personal variations in measuring, cutting and/or sewing. The enclosed directions were used in the construction of the original quilt.

Butterfly Kimono

1. **CENTER PANEL:** From CM2791 Flower Cart Panel, cut one piece 22½" x 43". Center the motifs in the design as desired. (Or refer to the photo to duplicate placement.)
2. From CM2820 Tide, cut one piece 22½" x 4". Sew to the bottom of the panel.
3. **COLLAR:** From CM2781 Tiny Check cut one piece 6½" x 4". Fold in half to measure 6½" x 2". Fold each corner diagonally to make raw edges meet. Attach to the center top of panel with folded corners right side up.
4. From CM2820 Tide, cut one piece 22½" x 4½". Sew to top of panel attaching simulated collar at the same time. Collar will only be attached at the seam. Set aside.

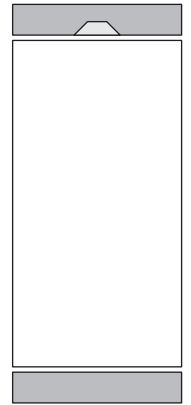

5. **SLEEVES:** From CX2792 Flower Festival, cut two pieces 5" wide x 19" high. NOTE This fabric has a one way design. Cut fabric so figures are upright.

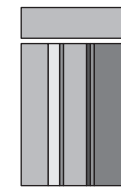

Left sleeve.

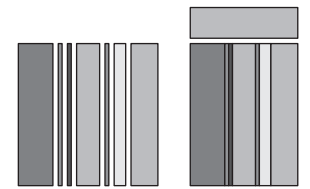

Right sleeve.

From CM2821 Asian Maple, cut two pieces 1" x 19". Sew one piece to the left side of one CX2792 Flower Festival, and one piece to the right side of the other piece of CX2792 Flower Festival.

Attach additional bands to each sleeve maintaining a right and left sleeve in the following sequence: From CX2793 Festival Background Red, cut two pieces 1" x 19"; from CM2795 Festival Blossoms Red, cut two pieces 3½" x 19"; from CM2821 Asian Maple, cut two pieces 1" x 19"; from CM2781 Asian Maple, cut two pieces 2" x 19"; from CM2820 Tide, cut two pieces 4" x 19" (this fabric has a one way design, though it is very subtle.)

Completed sleeve should measure 14½" wide x 19½" high raw edge to raw edge.

From CM2820 Tide, cut two pieces 14½" x 4½". Sew to the top of each sleeve panel. Set aside.

6. **RIGHT AND LEFT FRONT PANELS:** For the front sides of the kimono, work a right and left panel as for the sleeves. Sew fabrics together in the following order. Start with CM2526 Flower Cart and cut two pieces 6" wide x 22½" high. **NOTE:** This fabric has a one way design. Cut fabric so motifs are upright. Add additional strips to the left or right of CM2526 Flower Cart as follows: From CM2821 Asian Maple, cut two pieces 1" x 22½"; from CM1713 Maui Bliss, cut two pieces 1" x 22½"; from CM2425 River Crane, cut two pieces 2" x 22½"; from CX2793 Festival Background Red, cut two pieces 1" x 22½"; from CX2795 Festival Blossoms, cut two pieces 3 x 22½"; from CM2821 Asian Maple, cut two pieces 1" x 22½".

To create the triangle, diagonally draw a line from the top inside edge of CM2526 Flower Cart to the lower corner of CM2821 Asian Maple, adding ¼" seam allowance before cutting triangle unit.

From CM2781 Tiny Check, cut two pieces 2" x 17". Sew to outer side of each triangle unit. Attach from the top down – 5½" of the wedge will be left over. Turn under ¼" seam allowance on three sides of triangle unit that will be topstitched to CM2820 Tide.

From CM2820 Tide, cut two pieces 14½" x 28½". Place triangle unit in the upper right hand corner. Align outer edges. Top stitch in place. Trim away excess from the back. Sew panel to bottom edge of left sleeve panel. Repeat for right side, placing the wedge in the upper left hand corner of CM2820.

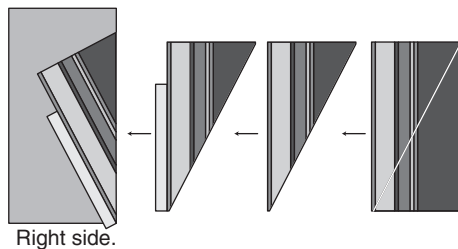
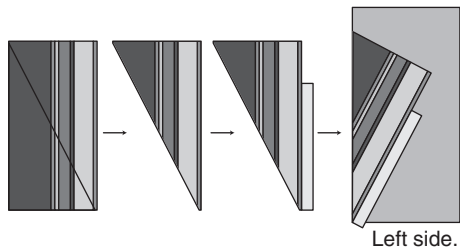

7. Sew left panel to center panel, matching lower edge of kimono hem and shoulder. Repeat for right panel.

8. From CX2868 Embellished Butterfly, cut five small butterflies and two large butterflies. Following manufacturer's instructions, iron onto fusible web. Cut out.

Scatter small butterflies only on the background as shown in the photo. Machine appliqué in place.

Iron large butterflies to the wrong side of any leftover fabric. Cut out. Machine satin stitch around all the edges to finish. Set aside.

9. Layer backing, batting, and quilt top. Quilt as desired.

10. From CX2793 Festival Background Green, cut binding strips 2½" wide. Stitch together along the short ends to get one continuous length of binding, approximately 218" long. Press binding in half wrong sides together. Attach to quilt top, turn to back and stitch in place.

11. Attach large butterflies to the center panel of the kimono, as desired. Attach only down the center of the body. The butterfly wings are loose and dimensional.

