

Bead Around

Bead Around

by Ronda Beyer

Finished Quilt approximately
46" x 46"

Krystal 1175 Purple	¾ yard
Krystal 1141 Orange	⅓ yard
Jet Black	⅝ yard
CM2533 Bead Floral col. black	1 yard
CM2534 Bead Mosaic col. black	¼ yard
CM2535 Bead Around, col. black	1¼ yard
Backing	2½ yards
Batting	50" x 50"

Iron-on Swarovski® Crystals from Kandi Corp. (optional)

505 Spray and Fix (optional)

Thread to match fabric for appliqué

Template plastic

Triangle Paper™ is an optional method of making half square triangles. It is available from Quilttime, 702-658-7988 or visit the web site at www.quilttime.com.

Disclaimers

1. This pattern is provided as a courtesy to quilt stores, catalogs, and quilters. Michael Miller Fabrics, LLC is NOT responsible for the accuracy of any kits packaged to accompany this pattern. Please direct any inquiries to the kit maker.
2. Yardage requirements for this pattern may allow for excess yardage to accommodate specific placement of motifs or to allow for any fussy-cutting to achieve the finished quilt design.
3. While every attempt has been made to give accurate measurements, yardage requirements and construction directions, this does not allow for personal variations in measuring, cutting and/or sewing. The enclosed directions were used in the construction of the original quilt.

1. From CM2534, cut 2 circles with a 7½" diameter. Cut 1 circle with a 7½" diameter from CM2535, and 1 circle from CM2533. The Mini Cut A Round ruler was used to cut the circles in this quilt. Turn seam allowance under ¼".

From Jet Black, cut 5 squares 10½" x 10½". Spray wrong side of circle with 505 Spray and Fix (optional) and center a circle on the right side of the 10½" square. Satin stitch, hand appliqué or machine appliqué the circles to the black squares. You will have 1 square left.

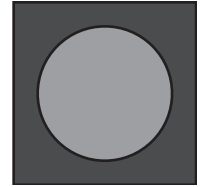

2. Trace templates to template plastic. The templates have the seam allowance included. From Krystal 1175, cut 16 pieces from Template A. From CM2533, cut 16 pieces from template B. From Krystal 1141, cut 16 pieces from Template C.

Following the graphic below, piece 16 A-B-C units together.

With right sides together, stitch B to A. Press seams toward A.

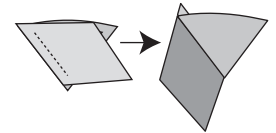

With right sides together, stitch B to C. Press seams toward C.

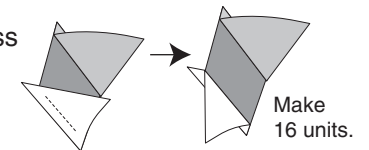

Place 2 units right sides together. Stitch template B piece to template A piece, starting and stopping stitching ¼" from edges.

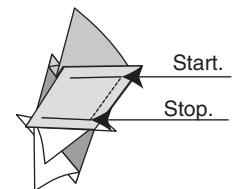

Pivot fabric so that template C piece is aligned with template B piece. Stitch template B piece to template A piece, starting and stopping stitching ¼" from edges.

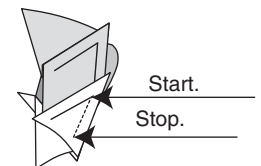

3. After circle is complete, turn outside edge under $\frac{1}{4}$ ". Satin stitch, hand or machine appliqué to the remaining black square. From CM2535, cut 1 circle with a $9\frac{1}{4}$ " diameter. Turn edges under $\frac{1}{4}$ " and satin stitch, hand or machine appliqué to the center of the star. Use 505 Spray and Fix to hold star to black square and center circle to star.

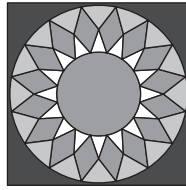

4. From CM2534, cut 1 square $16" \times 16"$, then cut into 4 diagonally. From CM2534, cut 2 squares $9\frac{1}{2}" \times 9\frac{1}{2}"$. Cut square into 2 diagonally.

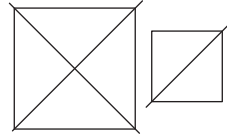

5. Piece blocks and triangles together diagonally into rows, then stitch the rows together. Once the quilt center is stitched together, square it to $29\frac{1}{2}" \times 29\frac{1}{2}"$.

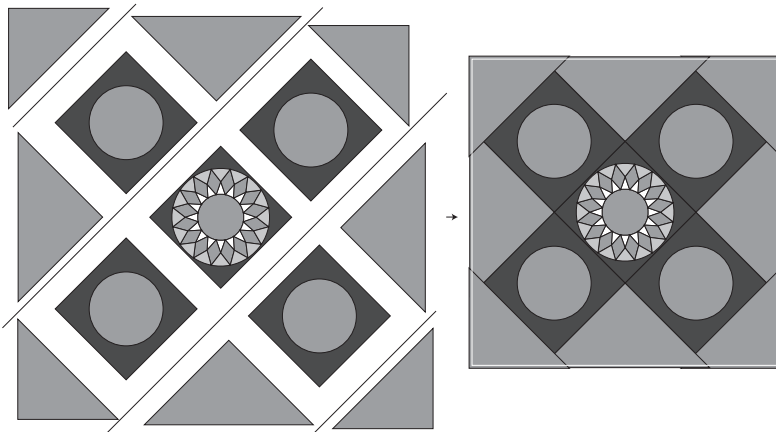

6. From Krystal 1141 bright orange, cut 4 strips $2"$ x width of fabric. Recut 2 strips to $29\frac{1}{2}"$. Stitch to the sides of the quilt. Recut remaining 2 strips to $32\frac{1}{2}"$ and stitch to the top and bottom of the quilt.
7. From Krystal 1175 purple and CM2533, cut 3 strips $2\frac{7}{8}"$ x width of fabric. Cross-cut into 32 squares $2\frac{7}{8}" \times 2\frac{7}{8}"$. Place squares of CM2533 right side together with Krystal 1175. Draw a line diagonally on each of the lighter squares. Stitch $\frac{1}{4}"$ on each side of the drawn line. Cut apart on drawn line, press seams toward darker fabric, and trim "dog-ears". Make 64 half square triangles.

From Krystal 1175, cut 4 squares $2\frac{1}{2}" \times 2\frac{1}{2}"$.

Piece half square triangles together into strips for a sawtooth border.

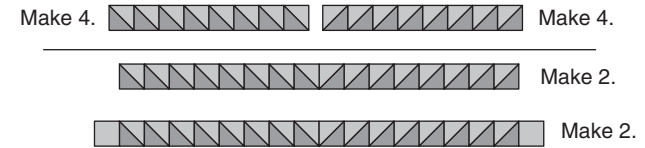

Stitch the $2\frac{1}{2}"$ squares to each end of 2 strips.

8. Stitch the shorter sawtooth strips to the sides of the quilt, and the longer strips to the top and bottom.
9. From CM 2535, cut 4 strips $5\frac{1}{2}"$ x width of fabric. Recut 2 strips to $36\frac{1}{2}"$ and stitch to the sides of the quilt. Recut remaining 2 strips to $46\frac{1}{2}"$ and stitch to the top and bottom of the quilt.

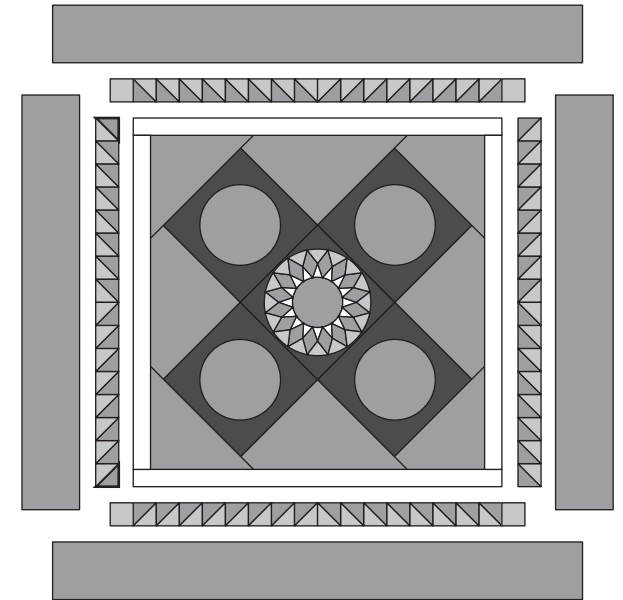

10. Layer, quilt, and bind. Cut binding strips $2\frac{1}{2}"$ wide from CM2535. Embellish with iron-on Swarovski® crystals, as desired.

